

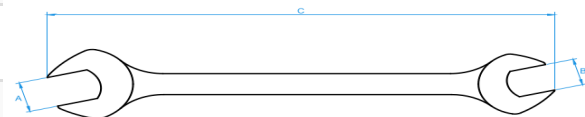

# DOUBLE ENDED OPEN JAW WRENCH

252 N - ISO 10102

Code	Hexagonal opening mm	"A" mm	"B" mm	"C" mm
U02520512	4x5	13,5	11	114
U02520513	5,5x7	17,5	15	121
U02520514	6x7	17,5	15	121
U02520516	7x8	22	19	138
U02520517	8x9	22	19	138
U02520518	8x10	22	19	143
U02520520	10x11	25	23	153
U02520522	10x13	29	23	163
U02520524	12x13	29,8	25,5	168
U02520525	12x14	29,8	25,5	177
U02520528	13x17	37	31	192
U02520529	14x15	33,5	31	182
U02520531	16x17	42	37	210
U02520533	17x19	42	39	220
U02520535	18x19	42	39	220
U02520536	19x22	48,5	43	242



800.909.4988  
info@rankinusa.com

**RANKIN**   
COMPONENTS THAT AUTOMATE



# DOUBLE ENDED OPEN JAW WRENCH

252 N - ISO 10102

Code	Hexagonal opening mm	"A" mm	"B" mm	"C" mm
U02520538	20x22	48,5	43	242
U02520539	21x23	52	47	242
U02520540	22x24	52	47	242
U02520541	24x26	58	53	270
U02520542	24x27	58	53	270
U02520543	25x28	64	59,5	28
U02520544	27x29	64	59,5	30
U02520545	27x30	64	59,5	30
U02520547	30x32	70	64	31
U02520550	34x36	75	71	34
U02520551	35x38	87	78	38
U02520552	36x41	87	78	38
U02520553	41x46	100	93	413
U02520554	46x50	106	101	442
U02520555	50x55	106	101	442

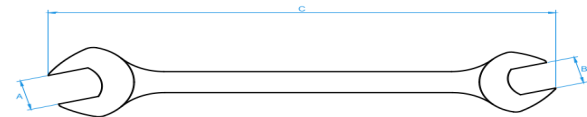

800.909.4988  
info@rankinusa.com

**RANKIN**   
COMPONENTS THAT AUTOMATE



# DOUBLE ENDED OPEN JAW WRENCH

252 N - ISO 10102

Code	Hexagonal opening mm	"A" mm	"B" mm	"C" mm
U02520511	3,5x5,5	13,5	11	110
U02520532	16x18	42	39	215
U02520556	26x28	64	59,5	285
U02520557	38x42	87	78	385

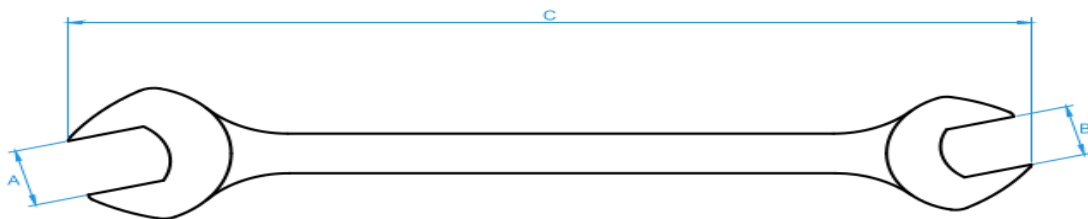

800.909.4988  
info@rankinusa.com

**RANKIN**   
COMPONENTS THAT AUTOMATE