

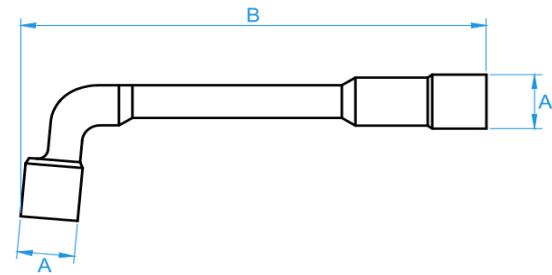

DOUBLE ENDED HOLLOW OFFSET SOCKET WRENCHES

291 N - ISO 2236 & ISO 691

Code	Hexagonal drive mm	"A" mm	"B" mm
U02910104	6	10	102
U02910105	7	11	106
U02910106	8	12,5	114
U02910107	9	13,5	122
U02910108	10	15	129
U02910109	11	16,5	136
U02910110	12	18	144
U02910111	13	19,5	152
U02910112	14	21	160
U02910113	15	22,5	169
U02910114	16	24	178
U02910115	17	25,5	187
U02910116	18	26,5	195
U02910117	19	28,5	204



800.909.4988
info@rankinusa.com





DOUBLE ENDED HOLLOW OFFSET SOCKET WRENCHES

291 N - ISO 2236 & ISO 691

Code	Hexagonal drive mm	"A" mm	"B" mm
U02910118	20	29,5	212
U02910119	21	30,5	221
U02910120	22	32	230
U02910121	23	33,5	240
U02910122	24	34,5	250
U02910123	25	36	260
U02910124	26	37	270
U02910125	27	38	280
U02910126	28	39,5	290
U02910128	30	42	310
U02910130	32	44,5	330

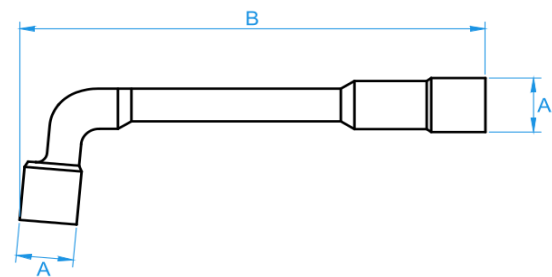

800.909.4988
info@rankinusa.com

RANKIN 
COMPONENTS THAT AUTOMATE