



INCREMENTAL ENCODER

**DESIGNED IN ORDER TO CONTROL THE POSITION
AND THE ANGULAR SPEED OF MOVING MECHANICAL AXES**

Main application field are: wood-working machinery, textile machines, CNC machinery, and so forth.

ELTRA brand encoders offers a complete range of encoders with resolution up to 24000 pulses per turn (ppr) with a wide flange choice and several electrical

interfaces. Shaft, blind hollow shaft and through hollow shaft up to a diameter of 60 mm (2.36") are available.

MAIN FEATURES

Miniaturized \varnothing 30 mm encoder series for application in small devices.
Recommended when a minimal size is required even providing excellent performances.

- 3 channel encoder (A / B / Z) up to 2500 ppr
- Power supply up to +28 V DC with several electrical interfaces available
- Up to 220 kHz output frequency
- Cable output, connector available on cable end
- Solid shaft diameter up to 6 mm
- Mounting by clamping or threaded flange



30 E (axial output)

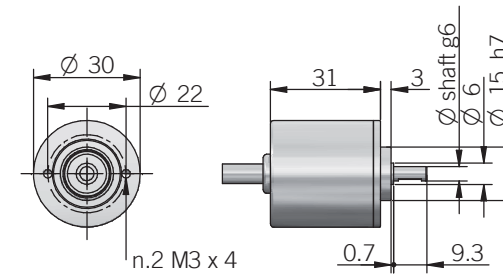

dimensions in mm

30 H (axial output)

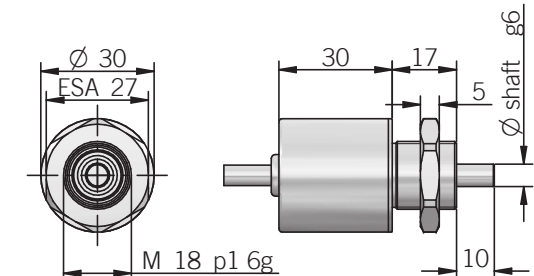

ORDERING CODE

EL	30E	50	S	5/28	C	4	X	3	PA	.XXX
<p>SERIES incremental encoder series EL incremental encoder series ER</p> <p>MODEL clamping flange \varnothing 15 mm 30E M18 threaded flange 30H</p> <p>RESOLUTION ppr from 1 to 2500 refer to the available pulses list</p> <p>ZERO PULSE without zero pulse S with zero pulse Z</p> <p>POWER SUPPLY (with L electrical interface) 5 V DC 5 5 ... 28 V DC 5/28</p> <p>ELECTRICAL INTERFACE NPN open collector C push-pull P line driver L power supply 5/28V - output RS-422 RS</p> <p>SHAFT DIAMETER (mod. E) mm 4 mm 6</p> <p>ENCLOSURE RATING IP 54 X</p> <p>MAX ROTATION SPEED 3000 rpm 3</p> <p>OUTPUT TYPE axial cable (standard length 0,5 m) PA radial cable (standard length 0,5 m) PR preferred cable lengths 1,5 / 2 / 3 / 5 / 10 m, to be added after OUTPUT TYPE (eg. PR5)</p> <p>VARIANT custom version XXX</p>										

ELECTRICAL SPECIFICATIONS

Resolution	from 1 to 2500 ppr
Power supply¹	5 = 4,5 ... 5,5 V DC 5/28 = 4,5 ... 30 V DC (reverse polarity protection)
Power draw without load	800 mW max
Max load current	C / P = 50 mA / channel L / RS = 20 mA / channel
Electrical interface²	NPN open collector (AEIC-7273, pull-up max +30 V DC) push-pull / line driver HTL (AEIC-7272) line driver RS-422 (AELT-5000 or equivalent)
Max output frequency	100 kHz EL series 220 kHz ER series
Counting direction	A leads B clockwise (shaft view)
Electromagnetic compatibility	according to 2014/30/EU directive
RoHS	according to 2015/863/EU directive
UL / CSA	certificate n. E212495

CONNECTIONS

Function	Cable C / P	Cable L / RS
+V DC	red	red
0 V	black	black
A+	green	green
A-	/	brown or grey
B+	yellow	yellow
B-	/	orange
Z+	blue	blue
Z-	/	white
⊖	shield	shield

MECHANICAL SPECIFICATIONS

Shaft diameter	\varnothing 4 / 6 mm
Enclosure rating	IP 54 (IEC 60529)
Max rotation speed	3000 rpm
Max shaft load³	5 N axial / radial
Shock	50 G, 11 ms (IEC 60068-2-27)
Vibration	10 G, 10 ... 2000 Hz (IEC 60068-2-6)
Moment of inertia	0,05 x 10 ⁻⁶ kgm ² (1,2 x 10 ⁻⁶ lbf ²)
Starting torque (at +20°C / +68°F)	< 0,005 Nm (0,71 Ozin)
Bearing stage material	EN-AW 2011 aluminum
Shaft material	1.4305 / AISI 303 stainless steel
Housing material	PAG6 glass fiber reinforced
Bearings	n.2 ball bearings
Bearings life	10 ⁹ revolutions
Operating temperature^{4,5}	-10° ... +60°C (+14° ... +140°F) EL series -25° ... +85°C (-13° ... +185°F) ER series
Storage temperature⁵	-25° ... +85°C (-13° ... +185°F)
Weight	70 g (2,47 oz)

¹ as measured at the transducer without cable influences

² for further details refer to OUTPUT LEVELS on TECHNICAL BASICS section

³ maximum load for static usage

⁴ measured on the transducer flange

⁵ condensation not allowed

EL SERIES RESOLUTIONS

1 - 10 - 20 - 25 - 50 - 60 - 64 - 150

ER SERIES RESOLUTIONS

100 - 128 - 200 - 250 - 256 - 300 - 360 - 400 - 500 - 512 - 600 - 625 - 720 - 800 - 1000 - 1024 - 1200 - 1250 - 1440 - 1600 - 2000 - 2048 - 2500

please directly contact our offices for other pulses, preferred resolutions in bold

EL - ER 40 A/B/C/H/I/N/X SOLID SHAFT INCREMENTAL ENCODER

MAIN FEATURES

Miniaturized $\varnothing 42$ mm encoder series for general factory automation applications.

- 3 channel encoder (A / B / Z) up to 14400 ppr
- Power supply up to +28 V DC with several electrical interfaces available
- Up to 500 kHz output frequency
- Cable output, connector available on cable end
- Solid shaft diameter up to 8 mm
- Mounting by clamping, threaded or synchronous flange



ORDERING CODE

ER	40A	100	S	5/28	P	6	X	6	P	R	.XXX
SERIES											
incremental encoder series EL											
incremental encoder series ER											
MODEL											
clamping flange $\varnothing 20$ mm 40A											
square flange $\square 36,5$ mm 40B											
clamping flange $\varnothing 17,46$ mm 40C											
M18 threaded flange 40H											
M20 threaded flange 40I											
synchronous flange $\varnothing 21$ mm 40N											
synchronous flange $\varnothing 30$ mm 40X											
RESOLUTION											
(mod. A / B) ppr from 1 to 14400											
(mod. C / H / I / N / X) ppr from 1 to 2500											
refer to the available pulses list											
ZERO PULSE											
without zero pulse S											
with zero pulse Z											
POWER SUPPLY											
(with L electrical interface) 5 V DC 5											
5 ... 28 V DC 5/28											
ELECTRICAL INTERFACE											
NPN open collector C											
push-pull P											
line driver L											
power supply 5/28V - output RS-422 RS											
SHAFT DIAMETER											
(mod. C) mm 4											
(mod. A / B / C / H / I / N) mm 6											
(mod. X) mm 8											
ENCLOSURE RATING											
IP 54 X											
(mod. A / B / H) IP 66 S											
MAX ROTATION SPEED											
(IP 66) 3000 rpm 3											
(IP 54) 6000 rpm 6											
OUTPUT TYPE											
cable (standard length 0,5 m) P											
preferred cable lengths 1,5 / 2 / 3 / 5 / 10 m, to be added after DIRECTION TYPE (eg. PR5)											
DIRECTION TYPE											
(mod. A / B / C / H / I / N) axial A											
radial R											
VARIANT											
custom version XXX											

OPTICAL SOLID SHAFT INCREMENTAL ENCODERS | EL - ER 40 A/B/C/H/I/N/X

40 A (IP54)

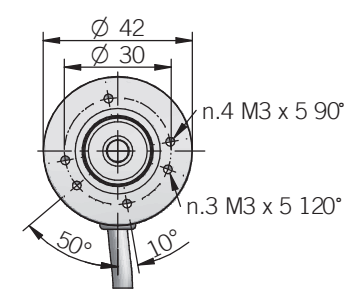

40 A (IP 66)

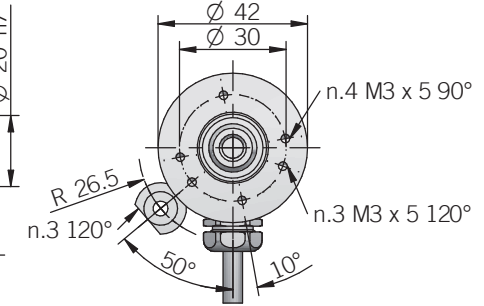

40 B (IP54)

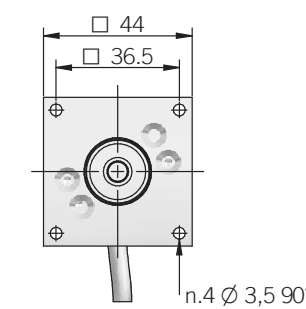

40 B (IP 66)

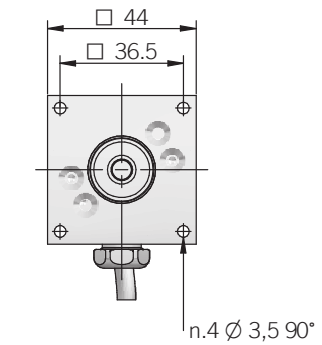

40 C

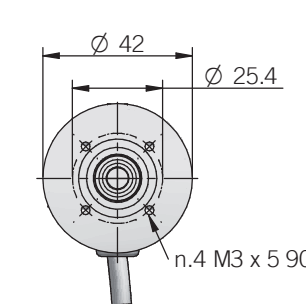

40 H

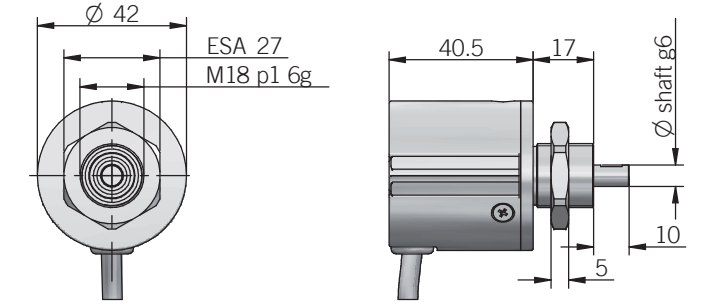

40 I

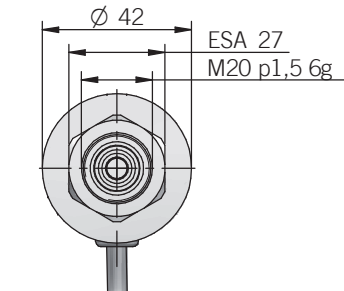

40 N

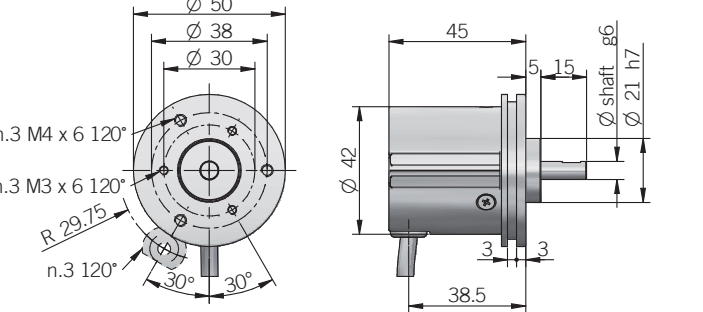

40 X

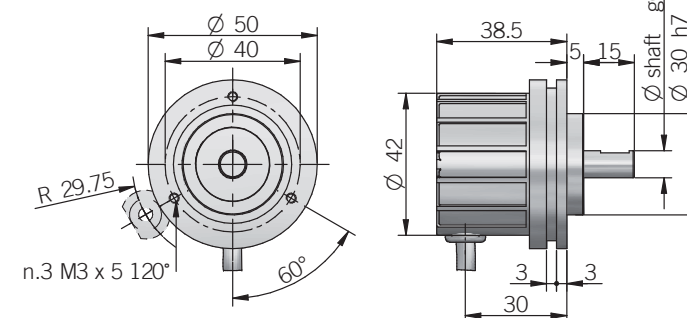

dimensions in mm

fixing clamps not included, please refer to the Accessories

40 (axial output)

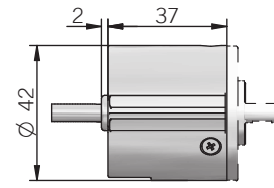

dimensions in mm

40 (IP 66 axial output)

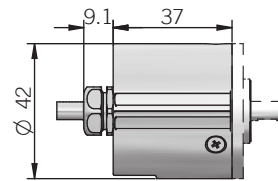

ELECTRICAL SPECIFICATIONS

Resolution	from 1 to 14400 ppr (mod. A / B) from 1 to 2500 ppr (mod. C / H / I / N / X)
Power supply¹	5 = 4,5 ... 5,5 V DC 5/28 = 4,5 ... 30 V DC (reverse polarity protection)
Power draw without load	800 mW max
Max load current	C / P = 50 mA / channel L / RS = 20 mA / channel
Electrical interface²	NPN open collector (AEIC-7273, pull-up max +30 V DC) push-pull / line driver HTL (AEIC-7272) line driver RS-422 (AELT-5000 or equivalent)
Max output frequency	EL series 150 kHz ER series 250 kHz up to 3600 ppr 500 kHz from 4000 ppr
Counting direction	A leads B clockwise (shaft view)
Electromagnetic compatibility	according to 2014/30/EU directive
RoHS	according to 2015/863/EU directive
UL / CSA	certificate n. E212495

CONNECTIONS

Function	Cable C / P	Cable L / RS
+V DC	red	red
0 V	black	black
A+	green	green
A-	/	brown or grey
B+	yellow	yellow
B-	/	orange
Z+	blue	blue
Z-	/	white
⊕	shield	shield

MECHANICAL SPECIFICATIONS

Shaft diameter	∅ 4 / 6 / 8 mm
Enclosure rating	X = IP 54 (IEC 60529) S = IP 66 (IEC 60529)
Max rotation speed	IP 54 - 6000 rpm IP 66 - 3000 rpm
Max shaft load³	5 N axial / radial
Shock	50 G, 11 ms (IEC 60068-2-27)
Vibration	10 G, 10 ... 2000 Hz (IEC 60068-2-6)
Moment of inertia	0,1 x 10 ⁻⁶ kgm ² (2,4 x 10 ⁻⁶ lbfm ²)
Starting torque (at +20°C / +68°F)	< 0,01 Nm (1,42 Ozin) IP 54 < 0,05 Nm (7,10 Ozin) IP 66
Bearing stage material	EN-AW 2011 aluminum
Shaft material	1.4305 / AISI 303 stainless steel
Housing material	PA66 glass fiber reinforced
Bearings	n.2 ball bearings
Bearings life	10 ⁹ revolutions
Operating temperature^{4,5}	-10° ... +60°C (+14° ... +140°F) EL series -25° ... +85°C (-13° ... +185°F) ER series
Storage temperature⁵	-25° ... +70°C (-13° ... +158°F)
Weight	100 g (3,52 oz)

¹ as measured at the transducer without cable influences

² for further details refer to OUTPUT LEVELS on TECHNICAL BASICS section

³ maximum load for static usage

⁴ measured on the transducer flange

⁵ condensation not allowed

EL SERIES RESOLUTIONS

1 - 2 - 4 - 5 - 10 - 15 - 16 - 20 - 30 - 32 - 40 - 50 - 70 - 80 - 90 - 750 - 1500

ER SERIES RESOLUTIONS

100 - 120 - 128 - 150 - 200 - 240 - 250 - 256 - 300 - 360 - 400 - 480 - 500 - 512 - 600 - 625 - 720 - 800 - 900 - 1000 - 1024 - 1200 - 1250 - 1440 - 1600 - 1800 - 2000 - 2048 - 2500 - 3000 - 3600 - 4000 - 4096 - 5000 - 6000 - 7200 - 8000 - 8192 - 10000 - 12000 - 14400

please directly contact our offices for other pulses, preferred resolutions in bold

MAIN FEATURES

Standard ∅ 58 mm encoder series for industrial applications with high mechanical resistance requirements. These encoders are designed to support high radial and axial shaft load and they can be mounted by means of flanges or fixing clamps.

- 3 channel encoder (A / B / Z) up to 24000 ppr
- Power supply up to +28 V DC with several electrical interfaces available
- Up to 500 kHz output frequency
- Cable or connector output
- Available with metal cover for heavy duty applications
- Solid shaft diameter up to 12 mm
- Mounting by synchronous, clamping or coupling flange



ORDERING CODE

ER	58C	M*	500	S	5/28	P	8	X	6	P	R	XXX	
SERIES incremental encoder series EL incremental encoder series ER		MODEL synchronous flange ∅ 50 mm 58B clamping flange ∅ 36 mm 58C clamping flange ∅ 50 mm 58H coupling flange ∅ 40 mm 58T		METAL COVER * add for metal cover M		RESOLUTION ppr from 1 to 24000 refer to the available pulses list		ZERO PULSE without zero pulse S with zero pulse Z		POWER SUPPLY (with L electrical interface) 5 V DC 5 5 ... 28 V DC 5/28		ELECTRICAL INTERFACE NPN open collector C push-pull P line driver L power supply 5/28V - output RS-422 RS	
SHAFT DIAMETER (mod. B) mm 6 (mod. C) mm 8 (mod. B / C / H) (3/8") mm 9,52 mm 10 (mod. T) mm 12		ENCLOSURE RATING IP 54 X (mod. B / C / T) IP 66 S		MAX ROTATION SPEED (IP 66) 3000 rpm 3 (IP 54) 6000 rpm 6		OUTPUT TYPE cable (standard length 1,5 m) P preferred cable lengths 2 / 3 / 5 / 10 m, to be added after DIRECTION TYPE (eg. PR5) MIL connector M JIS-C-5432 connector J M12 connector M12 M23 connector H IP40 IEC 60130-9 connector C female connector included, without female please add 162 as variant code		DIRECTION TYPE axial A radial R		VARIANT custom version XXX			

58 B

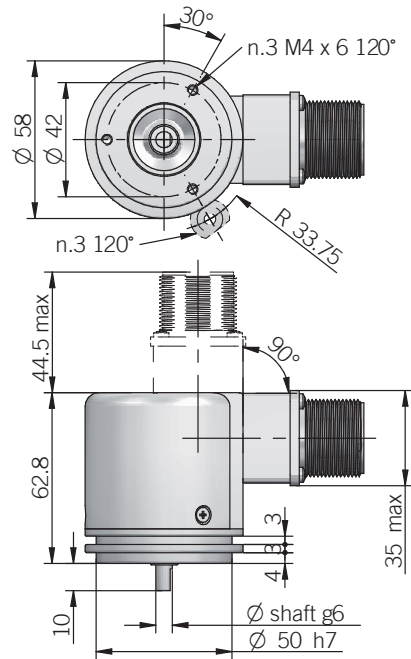

58 C

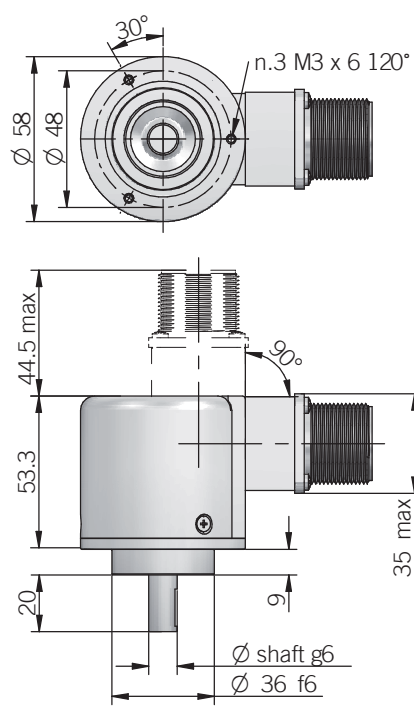

58 H

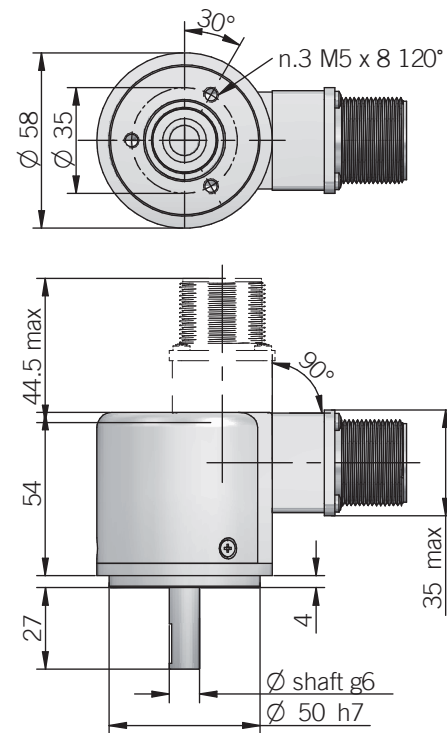

fixing clamps not included, please refer to Accessories

58 T

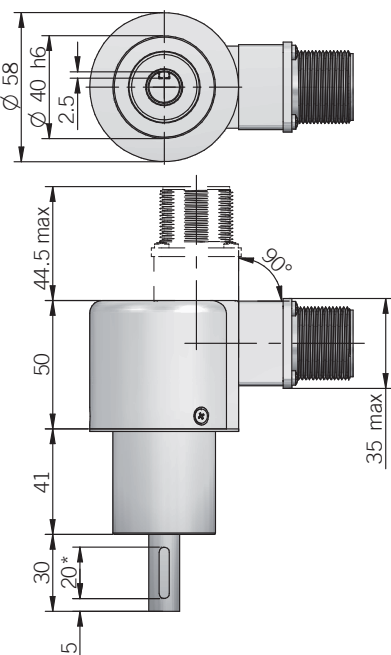

Dimension with metal cover and axial output

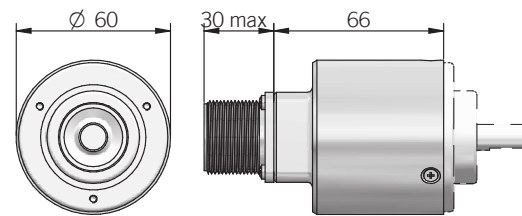

Dimension with metal cover and radial output

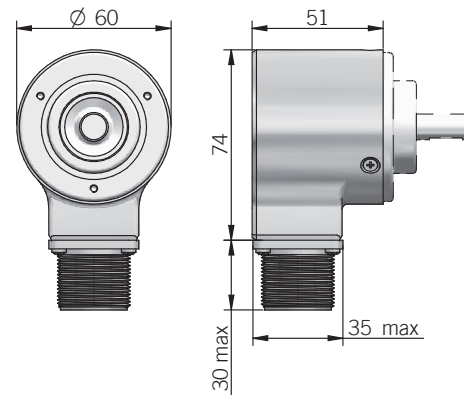

* slot only with 12mm shaft diameter dimensions in mm

ELECTRICAL SPECIFICATIONS

Resolution	from 1 to 24000 ppr
Power supply¹	5 = 4,5 ... 5,5 V DC 5/28 = 4,5 ... 30 V DC (reverse polarity protection)
Power draw without load	800 mW max
Max load current	C / P = 50 mA / channel L / RS = 20 mA / channel
Electrical interface²	NPN open collector (AEIC-7273, pull-up max +30 V DC) push-pull / line driver HTL (AEIC-7272) line driver RS-422 (AELT-5000 or equivalent)
Max output frequency	250 kHz up to 6000 ppr 500 kHz from 7200 ppr
Counting direction	A leads B clockwise (shaft view)
Electromagnetic compatibility	according to 2014/30/EU directive
RoHS	according to 2015/863/EU directive
UL / CSA	certificate n. E212495

EL SERIES RESOLUTIONS

1 - 2 - 4 - 5 - 10 - 15 - 16 - 20 - 25 - 30 - 32 - 40 - 50 - 60 - 70 - 80 - 90 - 160 - 180 - 350 - 450 - 660 - 700 - 750 - 1500

ER SERIES RESOLUTIONS

100 - 120 - 128 - 150 - 200 - 240 - 250 - 256 - 300 - **360** - 400 - 480 - **500** - **512** - **600** - 625 - **720** - 800 - 900 - **1000** - **1024** - 1200 - 1250 - 1440 - 1600 - 1800 - **2000** - **2048** - **2500** - 3000 - **3600** - 4000 - 4096 - **5000** - 6000 - **7200** - 8000 - 8192 - 9000 - **10000** - 10240 - 12000 - **14400** - 16000 - 16384 - 18000 - **20000** - 20480 - 24000

please directly contact our offices for other pulses, preferred resolutions in bold

MECHANICAL SPECIFICATIONS

Shaft diameter	Ø 6 / 8 / 9,52 (3/8") / 10 / 12 mm
Enclosure rating	X = IP 54 (IEC 60529) S = IP 66 (IEC 60529)
Max rotation speed	IP 54 - 6000 rpm IP 66 - EL 3000 rpm / 60° C ER 3000 rpm / 70° C - 2000 rpm / 85° C
Max shaft load³	10 N axial / 20 N radial with Ø6 mm shaft 200 N axial / radial
Shock	50 G, 11 ms (IEC 60068-2-27)
Vibration	10 G, 10 ... 2000 Hz (IEC 60068-2-6)
Moment of inertia	1,5 x 10 ⁻⁶ kgm ² (36 x 10 ⁻⁶ lbf ²)
Starting torque (at +20°C / +68°F)	< 0,02 Nm (2,83 Ozin) IP 54 < 0,06 Nm (8,50 Ozin) IP 66
Bearing stage material	EN-AW 2011 aluminum
Shaft material	1.4305 / AISI 303 stainless steel
Housing material	PA66 glass fiber reinforced / painted aluminum
Bearings	n.2 ball bearings
Bearings life	10 ⁹ revolutions
Operating temperature^{4,5}	-10° ... +60°C (+14° ... +140°F) EL series -25° ... +85°C (-13° ... +185°F) ER series
Storage temperature⁵	-25° ... +70°C (-13° ... +158°F)
Weight	350 g (12,35 oz) 450 g (15,87 oz) with metal cover

¹ as measured at the transducer without cable influences

² for further details refer to OUTPUT LEVELS on TECHNICAL BASICS section

³ maximum load for static usage

⁴ measured on the transducer flange

⁵ condensation not allowed

CONNECTIONS

Function	Cable C / P	Cable L / RS	7 pin J C / P	7 pin J L / RS no Zero	7 pin M C / P	7 pin M L / RS no Zero	10 pin J L / RS with Zero	10 pin M L / RS with Zero	5 pin M12 C / P	8 pin M12 L / RS	12 pin H	5 pin C C / P	8 pin C L / RS
+V DC	red	red	6	4	F	D	4 - 5	D - E	2	7	12	5	7
0 V	black	black	1	6	A	F	6	F	4	1	10	1	8
A+	green	green	3	1	C	A	1	A	3	6	5	2	1
A-	/	brown or grey	/	3	/	C	7	G	/	5	6	/	2
B+	yellow	yellow	5	2	E	B	2	B	1	4	8	4	3
B-	/	orange	/	5	/	E	8	H	/	3	1	/	4
Z+	blue	blue	4	/	D	/	3	C	5	2	3	3	5
Z-	/	white	/	/	/	/	9	I	/	8	4	/	6
⊕	shield	shield	7	7	G	G	10	J	housing	housing	9	/	/

J connector (7 pin)
JIS-C-5432 Size 16
solder side view FV

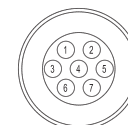

J connector (10 pin)
JIS-C-5432 Size 16
solder side view FV



M connector (7 pin)
Amphenol MS3102-E-16-S
solder side view FV

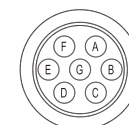

M connector (10 pin)
Amphenol MS3102-E-18-1
solder side view FV

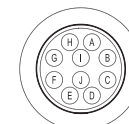

M12 connector (5 pin)
M12 A coded
solder side view FV

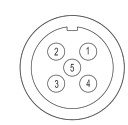

M12 connector (8 pin)
M12 A coded
solder side view FV

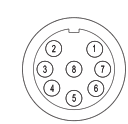

C connector (5 pin)
IEC 60130-9
solder side view FV



C connector (8 pin)
IEC 60130-9
solder side view FV

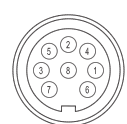

H connector (12 pin) - M23 CCW
Hummel 7.410.000000 -
7.002.912.603
solder side view FV



MAIN FEATURES

Standard \varnothing 63 mm encoder series for industrial applications with high mechanical resistance requirements. These encoders are designed to support high radial and axial shaft load and they can be mounted by means of flanges or fixing clamps.

- 3 channel encoder (A / B / Z) up to 24000 ppr
- Power supply up to +28 V DC with several electrical interfaces available
- Up to 500 kHz output frequency
- Cable or connector output
- Available with metal cover for heavy duty applications
- Solid shaft diameter up to 10 mm
- Mounting by synchronous or centering 2,5" square flange



ORDERING CODE

ER	63A	M*	500	S	5/28	P	8	X	6	P	R	.XXX
<p>SERIES incremental encoder series EL incremental encoder series ER</p> <p>MODEL synchronous flange \varnothing 31,75 mm 63A centering square flange \varnothing 31,75 mm 63D centering square flange \varnothing 50 mm 63E</p> <p>METAL COVER * add for metal cover M</p> <p>RESOLUTION ppr from 1 to 24000 refer to the available pulses list</p> <p>ZERO PULSE without zero pulse S with zero pulse Z</p> <p>POWER SUPPLY (with L electrical interface) 5 V DC 5 5 ... 28 V DC 5/28</p> <p>ELECTRICAL INTERFACE NPN open collector C push-pull P line driver L power supply 5/28V - output RS-422 RS</p> <p>SHAFT DIAMETER mm 8 (3/8") mm 9,52 mm 10</p> <p>ENCLOSURE RATING IP 54 X IP 66 S</p> <p>MAX ROTATION SPEED (IP 66) 3000 rpm 3 (IP 54) 6000 rpm 6</p> <p>OUTPUT TYPE cable (standard length 1,5 m) P preferred cable lengths 2 / 3 / 5 / 10 m, to be added after DIRECTION TYPE (eg. PR5) MIL connector M JIS-C-5432 connector J M12 connector M12 M23 connector H IP40 IEC 60130-9 connector C female connector included, without female please add 162 as variant code</p> <p>DIRECTION TYPE axial A radial R</p> <p>VARIANT custom version XXX</p>												

63 A

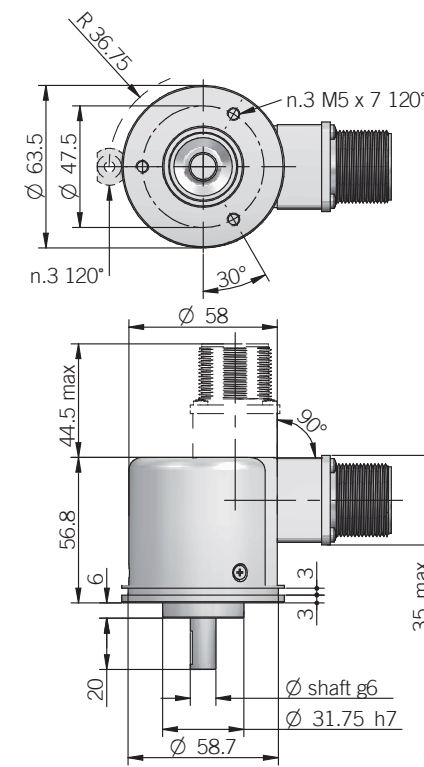

fixing clamps not included, please refer to Accessories

63 D

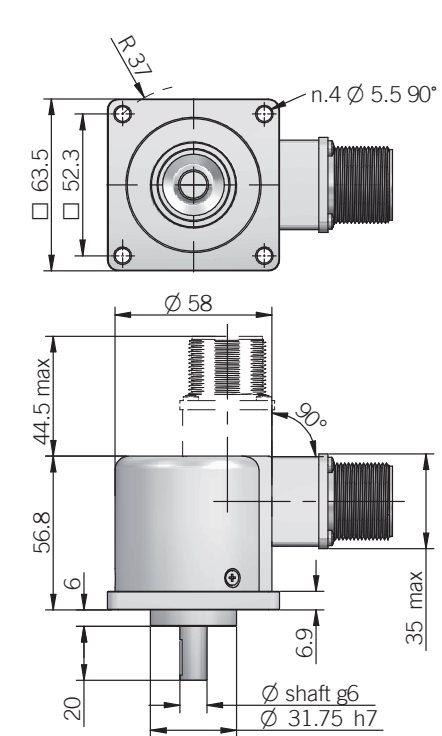

63 E

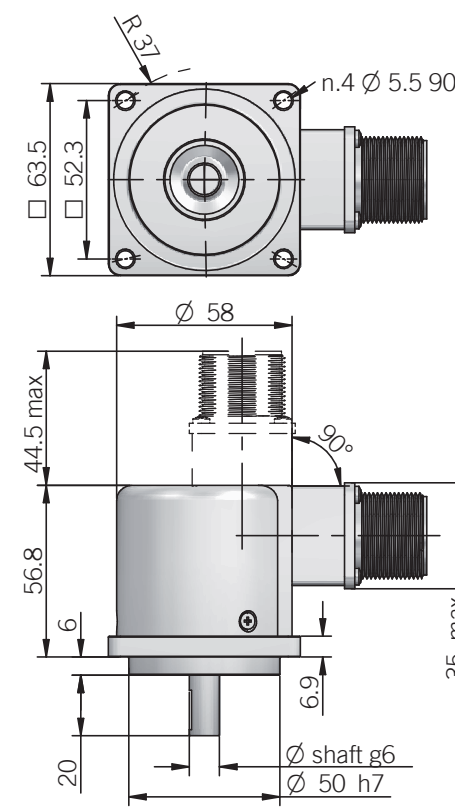

dimensions in mm

Dimension with metal cover and axial output

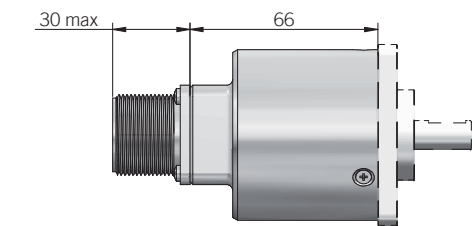

Dimension with metal cover and radial output

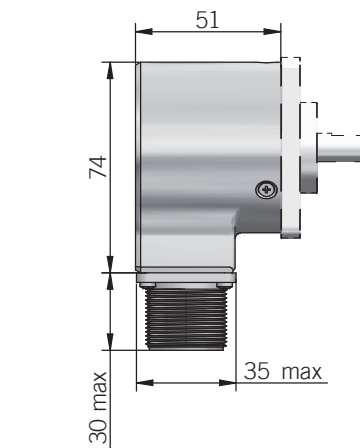

ELECTRICAL SPECIFICATIONS

Resolution	from 1 to 24000 ppr
Power supply¹	5 = 4,5 ... 5,5 V DC 5/28 = 4,5 ... 30 V DC (reverse polarity protection)
Power draw without load	800 mW max
Max load current	C / P = 50 mA / channel L / RS = 20 mA / channel
Electrical interface²	NPN open collector (AEIC-7273, pull-up max +30 V DC) push-pull / line driver HTL (AEIC-7272) line driver RS-422 (AELT-5000 or equivalent)
Max output frequency	250 kHz up to 6000 ppr 500 kHz from 7200 ppr
Counting direction	A leads B clockwise (shaft view)
Electromagnetic compatibility	according to 2014/30/EU directive
RoHS	according to 2015/863/EU directive
UL / CSA	certificate n. E212495

EL SERIES RESOLUTIONS

1 - 2 - 4 - 5 - 10 - 15 - 16 - 20 - 25 - 30 - 32 - 40 - 50 - 60 - 70 - 80 - 90 - 160 - 180 - 350 - 450 - 660 - 700 - 750 - 1500

ER SERIES RESOLUTIONS

100 - 120 - 128 - 150 - 200 - 240 - 250 - 256 - 300 - **360** - 400 - 480 - **500** - **512** - **600** - 625 - **720** - 800 - 900 - **1000** - **1024** - 1200 - 1250 - 1440 - 1600 - 1800 - **2000** - **2048** - **2500** - 3000 - **3600** - 4000 - 4096 - **5000** - 6000 - **7200** - 8000 - 8192 - 9000 - **10000** - 10240 - 12000 - **14400** - 16000 - 16384 - 18000 - **20000** - 20480 - 24000

please directly contact our offices for other pulses, preferred resolutions in bold

CONNECTIONS

Function	Cable C / P	Cable L / RS	7 pin J C / P	7 pin J L / RS no Zero	7 pin M C / P	7 pin M L / RS no Zero	10 pin J L / RS with Zero	10 pin M L / RS with Zero	5 pin M12 C / P	8 pin M12 L / RS	12 pin H	5 pin C C / P	8 pin C L / RS
+V DC	red	red	6	4	F	D	4 - 5	D - E	2	7	12	5	7
0 V	black	black	1	6	A	F	6	F	4	1	10	1	8
A+	green	green	3	1	C	A	1	A	3	6	5	2	1
A-	/	brown or grey	/	3	/	C	7	G	/	5	6	/	2
B+	yellow	yellow	5	2	E	B	2	B	1	4	8	4	3
B-	/	orange	/	5	/	E	8	H	/	3	1	/	4
Z+	blue	blue	4	/	D	/	3	C	5	2	3	3	5
Z-	/	white	/	/	/	/	9	I	/	8	4	/	6
≡	shield	shield	7	7	G	G	10	J	housing	housing	9	/	/

<p>J connector (7 pin) JIS-C-5432 Size 16 solder side view FV</p>	<p>M connector (7 pin) Amphenol MS3102-E-16-S solder side view FV</p>	<p>M12 connector (5 pin) M12 A coded solder side view FV</p>	<p>C connector (5 pin) IEC 60130-9 solder side view FV</p>	<p>H connector (12 pin) - M23 CCW Hummel 7.410.000000 - 7.002.912.603 solder side view FV</p>
<p>J connector (10 pin) JIS-C-5432 Size 16 solder side view FV</p>	<p>M connector (10 pin) Amphenol MS3102-E-18-1 solder side view FV</p>	<p>M12 connector (8 pin) M12 A coded solder side view FV</p>	<p>C connector (8 pin) IEC 60130-9 solder side view FV</p>	

MECHANICAL SPECIFICATIONS

Shaft diameter	ø 8 / 9,52 (3/8") / 10 mm
Enclosure rating	X = IP 54 (IEC 60529) S = IP 66 (IEC 60529)
Max rotation speed	IP 54 - 6000 rpm IP 66 - EL 3000 rpm / 60° C ER 3000 rpm / 70° C - 2000 rpm / 85° C
Max shaft load³	200 N axial / radial
Shock	50 G, 11 ms (IEC 60068-2-27)
Vibration	10 G, 10 ... 2000 Hz (IEC 60068-2-6)
Moment of inertia	1,5 x 10 ⁻⁶ kgm ² (36 x 10 ⁻⁶ lbfm ²)
Starting torque (at +20°C / +68°F)	< 0,02 Nm (2,83 Ozin) IP 54 < 0,06 Nm (8,50 Ozin) IP 66
Bearing stage material	EN-AW 2011 aluminum
Shaft material	1.4305 / AISI 303 stainless steel
Housing material	PA66 glass fiber reinforced / painted aluminum
Bearings	n.2 ball bearings
Bearings life	10 ⁹ revolutions
Operating temperature^{4,5}	-10° ... +60°C (+14° ... +140°F) EL series -25° ... +85°C (-13° ... +185°F) ER series
Storage temperature⁵	-25° ... +70°C (-13° ... +158°F)
Weight	350 g (12,35 oz) 450 g (15,87 oz) with metal cover

¹ as measured at the transducer without cable influences
² for further details refer to OUTPUT LEVELS on TECHNICAL BASICS section
³ maximum load for static usage
⁴ measured on the transducer flange
⁵ condensation not allowed

MAIN FEATURES

Explosion proof encoder for applications within explosive and hazardous areas.

- 3 channel encoder (A / B / Z) up to 10000 ppr
- Power supply up to +28 V DC with several electrical interfaces available
- Up to 500 kHz output frequency
- 10 mm solid shaft diameter
- Mounting by synchronous or centering square flange

EX CLASSIFICATION

It has been assured with EC-TYPE Examination Certificate CESI 04 ATEX 082 that the EX 80 comply with essential health and safety requirements according to

- EN 60079-0:2012+A11:2013
- EN 60079-1:2014
- EN 60079-31:2014

The UE declaration is available on www.eltra.it



ORDERING CODE

EX	80A	500	S	5/28	P	10	X	3	PR	.XXX
SERIES explosion proof encoder series EX										
MODEL synchronous flange ø 40 mm 80A centering square flange ø 40 mm 80D										
RESOLUTION ppr from 100 to 10000 refer to the available pulses list										
ZERO PULSE without zero pulse S with zero pulse Z										
POWER SUPPLY (with L electrical interface) 5 V DC 5 5 ... 28 V DC 5/28										
ELECTRICAL INTERFACE NPN open collector C push-pull P line driver L power supply 5/28V - output RS-422 RS										
SHAFT DIAMETER mm 10										
ENCLOSURE RATING IP 65 X										
MAX ROTATION SPEED 3000 rpm 3										
OUTPUT TYPE radial cable (standard length 1,5 m) PR preferred cable lengths 2 / 3 / 5 / 10 m, to be added after OUTPUT TYPE (eg. PR5)										
VARIANT custom version XXX										

EL - ER 90 A EL - ER 115 A

SOLID SHAFT INCREMENTAL ENCODER

MAIN FEATURES

Encoder series for harsh environments with high mechanical resistance requirements. Model 90 can be mounted by flanges or fixing clamps; model 115 has a tachometer generator REO-444 type compatible plug.

- 3 channel encoder (A / B / Z) up to 10000 ppr
- Power supply up to +28 V DC with several electrical interfaces available
- Up to 500 kHz output frequency
- Cable or connector output
- Metal cover for heavy duty applications
- Solid shaft diameter up to 11 mm
- Mounting by synchronous or REO-444 flange



ORDERING CODE

ER	90A	500	S	5/28	P	8	X	6	P	R	.XXX
<p>SERIES incremental encoder series EL incremental encoder series ER</p> <p>MODEL synchronous flange \varnothing 40 mm 90A flange REO-444 115A</p> <p>RESOLUTION ppr from 1 to 10000 refer to the available pulses list</p> <p>ZERO PULSE without zero pulse S with zero pulse Z</p> <p>POWER SUPPLY (with L electrical interface) 5 V DC 5 5 ... 28 V DC 5/28</p> <p>ELECTRICAL INTERFACE NPN open collector C push-pull P line driver L power supply 5/28V - output RS-422 RS</p> <p>SHAFT DIAMETER (mod. 90) mm 8 (mod. 90) (3/8") mm 9,52 mm 10 (mod. 115) mm 11</p> <p>ENCLOSURE RATING IP 54 X (mod. 90) IP 66 S</p> <p>MAX ROTATION SPEED (IP 66) 3000 rpm 3 (IP 54) 6000 rpm 6</p> <p>OUTPUT TYPE cable (standard length 1.5 m) P preferred cable lengths 2 / 3 / 5 / 10 m, to be added after DIRECTION TYPE (eg. PR5) MIL connector M JIS-C-5432 connector J female connector included, without female please add 162 as variant code</p> <p>DIRECTION TYPE axial A radial R</p> <p>VARIANT custom version XXX</p>											

90 A

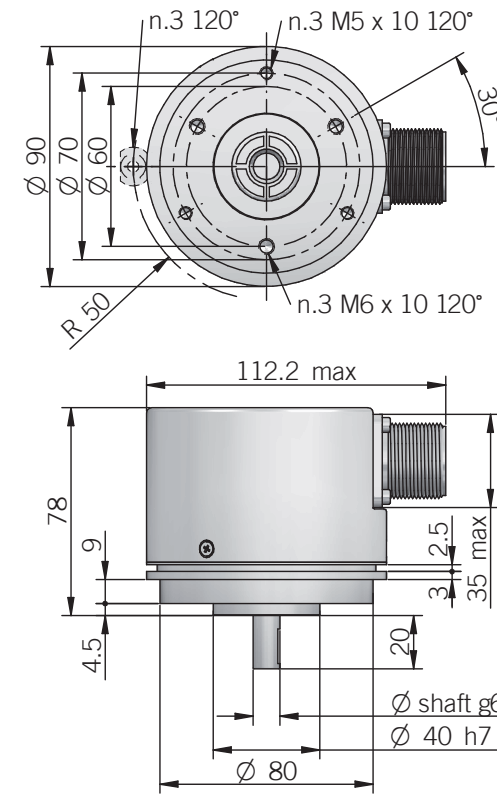

fixing clamps not included, please refer to Accessories

90 A axial output

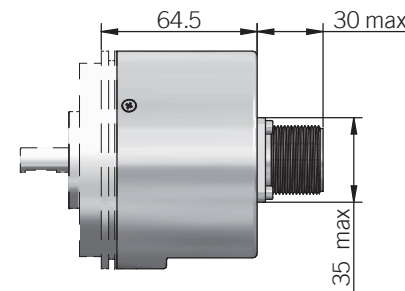

dimensions in mm

115 A

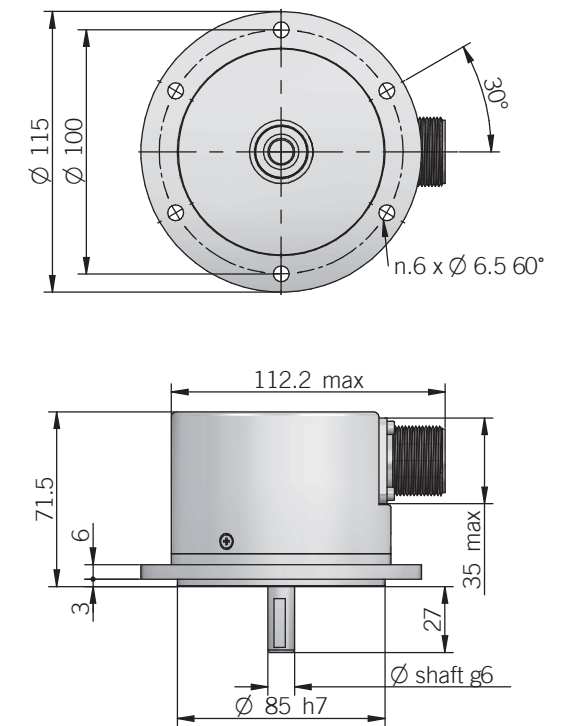

115 A axial output

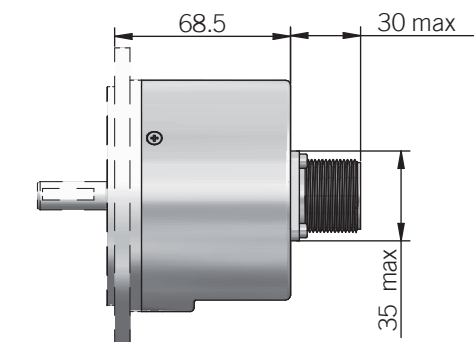

53 A

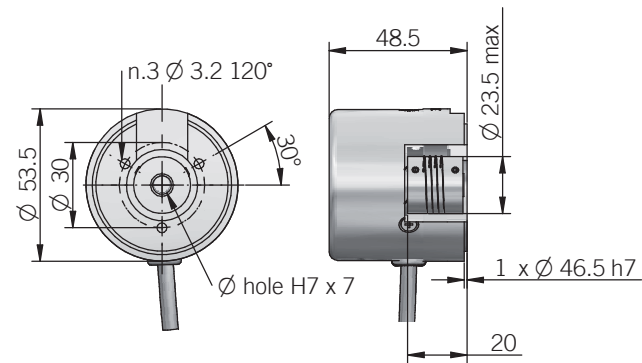

dimensions in mm

53 B interface

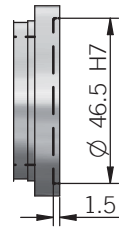

ELECTRICAL SPECIFICATIONS

Resolution	from 100 to 1024 ppr
Power supply¹	5 = 4,5 ... 5,5 V DC 8/24 = 7,6 ... 25,2 V DC (reverse polarity protection)
Current consumption without load	100 mA max
Max load current	C / P = 50 mA / channel L = 20 mA / channel
Electrical interface²	NPN open collector (pull-up max +30V DC) push-pull / line driver HTL (AEIC-7272) line driver RS-422 (AELT-5000 or equivalent)
Max output frequency	150 kHz
Counting direction	A leads B clockwise (shaft view)
Electromagnetic compatibility	according to 2014/30/EU directive
RoHS	according to 2015/863/EU directive
UL / CSA	certificate n. E212495

CONNECTIONS

Function	Cable C / P	Cable L
+V DC	red	red
0 V	black	black
A+	green	green
A-	/	brown or grey
B+	yellow	yellow
B-	/	orange
Z+	blue	blue
Z-	/	white
⊕	shield	shield

MECHANICAL SPECIFICATIONS

Bore diameter	∅ 6 / 8 / 10 mm
Enclosure rating	IP 54 (IEC 60529)
Max rotation speed	6000 rpm
Shock	50 G, 11 ms (IEC 60068-2-27)
Vibration	10 G, 10 ... 2000 Hz (IEC 60068-2-6)
Moment of inertia	1 x 10 ⁻⁶ kgm ² (24 x 10 ⁻⁶ lbf ²)
Starting torque (at +20°C / +68°F)	< 0,01 Nm (1,42 Ozin)
Bearing stage material	EN-AW 2011 aluminum
Shaft material	1.4305 / AISI 303 stainless steel
Housing material	PAG6 glass fiber reinforced
Bearings	n.2 ball bearings
Bearings life	10 ⁹ revolutions
Operating temperature^{3,4}	-10° ... +60°C (+14° ... +140°F)
Storage temperature⁴	-25° ... +70°C (-13° ... +158°F)
Weight	150 g (5,29 oz)

¹ as measured at the transducer without cable influences
² for further details refer to OUTPUT LEVELS on TECHNICAL BASICS section
³ measured on the transducer flange
⁴ condensation not allowed

RESOLUTIONS

50 - 100 - 120 - 125 - 128 - 150 - 180 - 200 - 250 - 256 - 300 - 360 - 400 - 500 - 512 - 600 - 720 - 1000 - 1024

please directly contact our offices for other pulses

MAIN FEATURES

Encoder series for direct mounting on motors; integrated elastic coupling allows radial and axial shaft play.

- 3 channel encoder (A / B / Z) up to 10000 ppr
- Power supply up to +28 V DC with several electrical interfaces available
- Up to 500 kHz output frequency
- Cable or connector output
- Available with metal cover for heavy duty applications
- Integrated elastic couplig up to 10 mm bore diameter



ORDERING CODE

ER	53A	M*	500	S	5/28	P	8	X	6	P	R	XXX	
SERIES incremental encoder series EL incremental encoder series ER		MODEL adjustable flange model 53A adjustable flange model 53B	METAL COVER * add for metal cover M	RESOLUTION ppr from 1 to 10000 refer to the available pulses list	ZERO PULSE without zero pulse S with zero pulse Z	POWER SUPPLY (with L electrical interface) 5 V DC 5 5 ... 28 V DC 5/28	ELECTRICAL INTERFACE NPN open collector C push-pull P line driver L power supply 5/28V - output RS-422 RS	BORE DIAMETER mm 6 mm 8 mm 10	ENCLOSURE RATING IP 54 X IP 64 S	MAX ROTATION SPEED (IP 64) 3000 rpm 3 (IP 54) 6000 rpm 6	OUTPUT TYPE cable (standard length 1,5 m) P preferred cable lengths 2 / 3 / 5 / 10 m, to be added after DIRECTION TYPE (eg. PR5) MIL connector M JIS-C-5432 connector J M12 connector M12 M23 connector H IP40 IEC 60130-9 connector C female connector included, without female please add 162 as variant code	DIRECTION TYPE axial A radial R	VARIANT custom version XXX

53 A

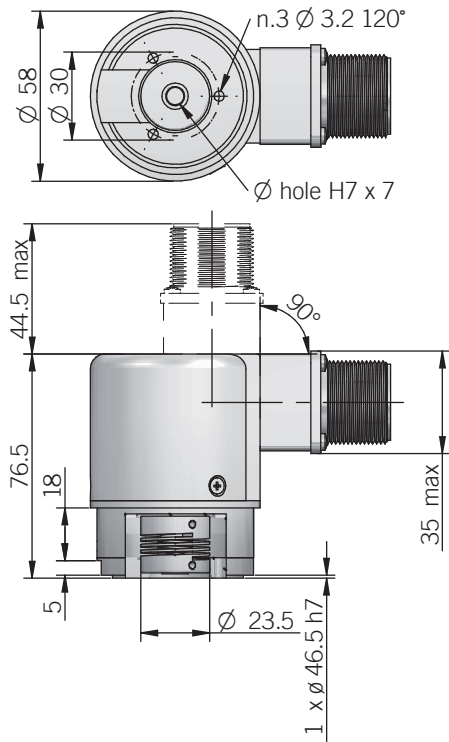

53 B interface

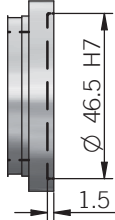

dimensions in mm

Dimensions with metal cover and axial output

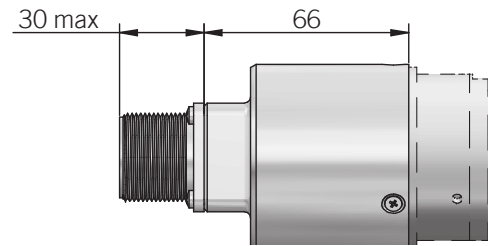

Dimensions with metal cover and radial output

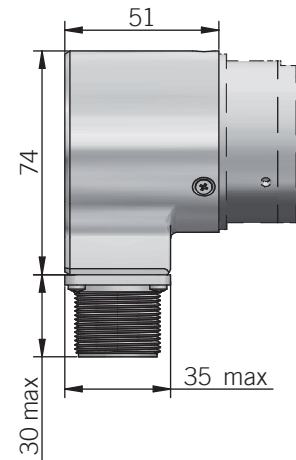

ELECTRICAL SPECIFICATIONS

Resolution	from 1 to 10000 ppr
Power supply¹	5 = 4,5 ... 5,5 V DC 5/28 = 4,5 ... 30 V DC (reverse polarity protection)
Power draw without load	800 mW
Max load current	C / P = 50 mA / channel L / RS = 20 mA / channel
Electrical interface²	NPN open collector (AEIC-7273, pull-up max +30 V DC) push-pull / line driver HTL (AEIC-7272) line driver RS-422 (AELT-5000 or equivalent)
Max output frequency	250 kHz up to 6000 ppr 500 kHz from 7200 ppr
Counting direction	A leads B clockwise (shaft view)
Electromagnetic compatibility	according to 2014/30/EU directive
RoHS	according to 2015/863/EU directive
UL / CSA	certificate n. E212495

EL SERIES RESOLUTIONS

1 - 2 - 4 - 5 - 10 - 15 - 16 - 20 - 25 - 30 - 32 - 40 - 50 - 60 - 70 - 80 - 90 - 160 - 180 - 350 - 450 - 660 - 700 - 750 - 1500

ER SERIES RESOLUTIONS

100 - 120 - 128 - 150 - 200 - 240 - 250 - 256 - 300 - **360** - 400 - 480 - **500** - **512** - **600** - 625 - **720** - 800 - 900 - **1000** - **1024** - 1200 - 1250 - 1440 - 1600 - 1800 - **2000** - **2048** - **2500** - 3000 - **3600** - 4000 - 4096 - **5000** - 6000 - **7200** - 8000 - 8192 - 9000 - **10000**

please directly contact our offices for other pulses, preferred resolutions in bold

MECHANICAL SPECIFICATIONS

Bore diameter	ø 6 / 8 / 10 mm
Enclosure rating	X = IP 54 (IEC 60529) S = IP 64 (IEC 60529)
Max rotation speed	IP 64 - 3000 rpm IP 54 - 6000 rpm
Shock	50 G, 11 ms (IEC 60068-2-27)
Vibration	10 G, 10 ... 2000 Hz (IEC 60068-2-6)
Moment of inertia	1 x 10 ⁻⁶ kgm ² (24 x 10 ⁻⁶ lbf ²)
Starting torque (at +20°C / +68°F)	< 0,01 Nm (1,42 Ozin)
Bearing stage material	EN-AW 2011 aluminum
Shaft material	1.4305 / AISI 303 stainless steel
Housing material	PA66 glass fiber reinforced / painted aluminum
Bearings	n.2 ball bearings
Bearings life	10 ⁹ revolutions
Operating temperature^{3,4}	-10° ... +60°C (+14° ... +140°F) -25° ... +85°C (-13° ... +185°F) ER series
Storage temperature⁴	-25° ... +70°C (-13° ... +158°F)
Weight	350 g (12,35 oz)

¹ as measured at the transducer without cable influences

² for further details refer to OUTPUT LEVELS on TECHNICAL BASICS section

³ measured on the transducer flange

⁴ condensation not allowed

CONNECTIONS

Function	Cable C / P	Cable L / RS	7 pin J C / P	7 pin J L / RS no Zero	7 pin M C / P	7 pin M L / RS no Zero	10 pin J L / RS with Zero	10 pin M L / RS with Zero	5 pin M12 C / P	8 pin M12 L / RS	12 pin H	5 pin C C / P	8 pin C L / RS
+V DC	red	red	6	4	F	D	4 - 5	D - E	2	7	12	5	7
0 V	black	black	1	6	A	F	6	F	4	1	10	1	8
A+	green	green	3	1	C	A	1	A	3	6	5	2	1
A-	/	brown or grey	/	3	/	C	7	G	/	5	6	/	2
B+	yellow	yellow	5	2	E	B	2	B	1	4	8	4	3
B-	/	orange	/	5	/	E	8	H	/	3	1	/	4
Z+	blue	blue	4	/	D	/	3	C	5	2	3	3	5
Z-	/	white	/	/	/	/	9	I	/	8	4	/	6
≡	shield	shield	7	7	G	G	10	J	housing	housing	9	/	/

J connector (7 pin)
JIS-C-5432 Size 16
solder side view FV

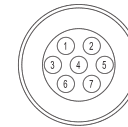

M connector (7 pin)
Amphenol MS3102-E-16-S
solder side view FV

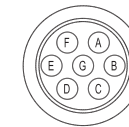

M12 connector (5 pin)
M12 A coded
solder side view FV

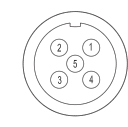

C connector (5 pin)
IEC 60130-9
solder side view FV

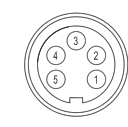

H connector (12 pin) - M23 CCW
Hummel 7.410.000000 -
7.002.912.603
solder side view FV



J connector (10 pin)
JIS-C-5432 Size 16
solder side view FV

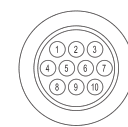

M connector (10 pin)
Amphenol MS3102-E-18-1
solder side view FV



M12 connector (8 pin)
M12 A coded
solder side view FV

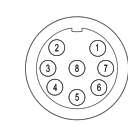

C connector (8 pin)
IEC 60130-9
solder side view FV



MAIN FEATURES

Hollow shaft encoder series for industrial applications with high mechanical resistance requirements. These encoders are designed to withstand high radial and axial shaft loads.

- 3 channel encoder (A / B / Z) up to 24000 ppr
- Power supply up to +28 V DC with several electrical interfaces available
- Up to 500 kHz output frequency
- Cable or connector output
- Available with metal cover for heavy duty applications
- Blind hollow shaft diameter up to 15 mm
- Mounting by stator coupling, torque stop slot or torque pin



ORDERING CODE

ER	58F	M*	500	S	5/28	P	8	X	3	P	R	.XXX
<p>SERIES incremental encoder series EL incremental encoder series ER</p> <p>MODEL blind hollow shaft with stator coupling 58F blind hollow shaft with torque pin 58G blind hollow shaft with torque stop slot 63F blind hollow shaft with torque pin 63G</p> <p>METAL COVER * add for metal cover M</p> <p>RESOLUTION ppr from 1 to 24000 refer to the available pulses list</p> <p>ZERO PULSE without zero pulse S with zero pulse Z</p> <p>POWER SUPPLY (with L electrical interface) 5 V DC 5 5 ... 28 V DC 5/28</p> <p>ELECTRICAL INTERFACE NPN open collector C push-pull P line driver L power supply 5/28V - output RS-422 RS</p> <p>BORE DIAMETER mm 8 mm 10 mm 12 mm 14 mm 15</p> <p>ENCLOSURE RATING IP 54 X IP 66 S</p> <p>MAX ROTATION SPEED 3000 rpm 3</p> <p>OUTPUT TYPE cable (standard length 1,5 m) P preferred cable lengths 2 / 3 / 5 / 10 m, to be added after DIRECTION TYPE (eg. PR5) MIL connector M JIS-C-5432 connector J M12 connector M12 M23 connector H IP40 IEC 60130-9 connector C female connector included, without female please add 162 as variant code</p> <p>DIRECTION TYPE axial A radial R</p> <p>VARIANT custom version XXX</p>												

58 F

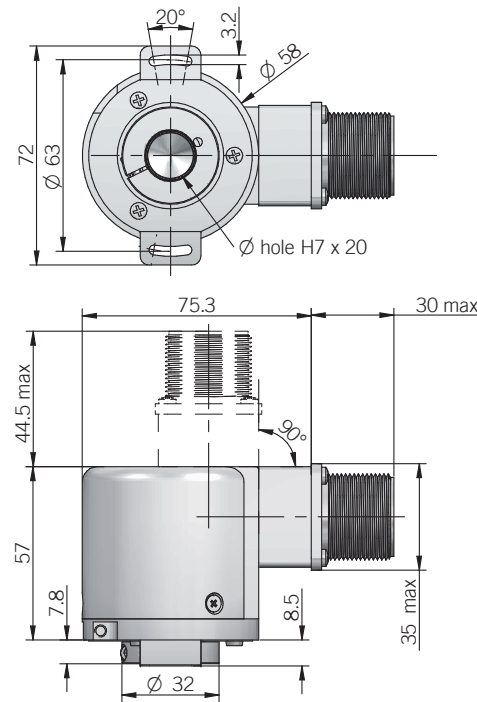

58 G

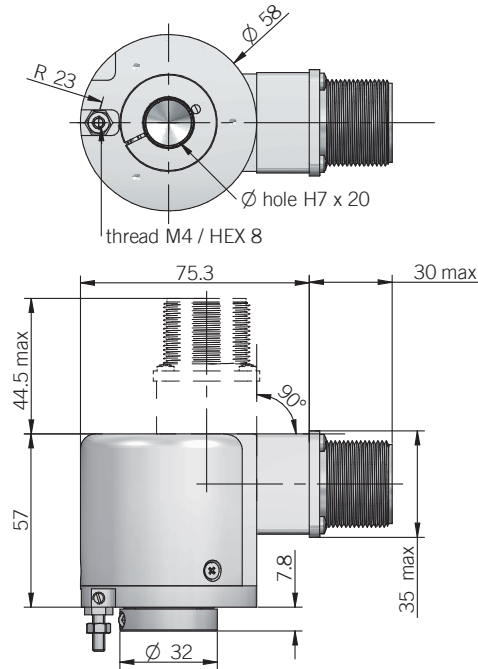

63 F

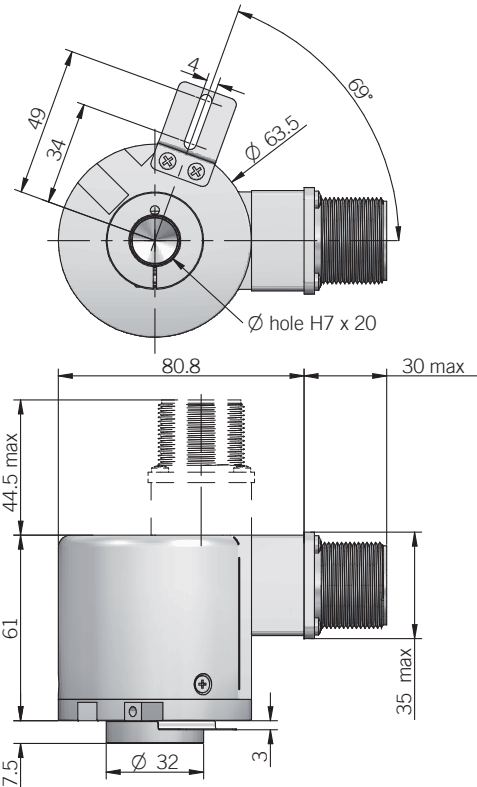

63 G

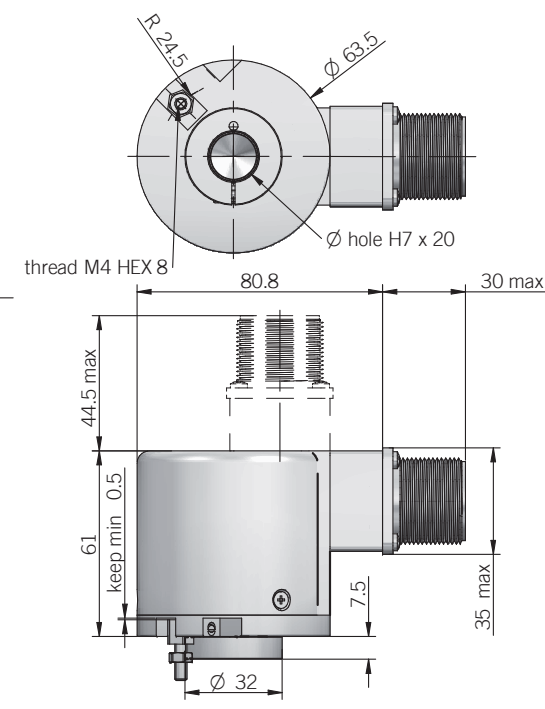

Dimensions with metal cover and axial output

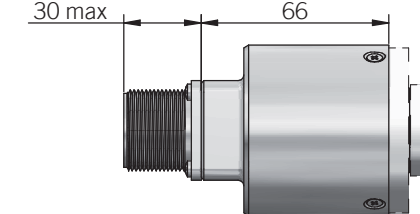

Dimensions with metal cover and radial output

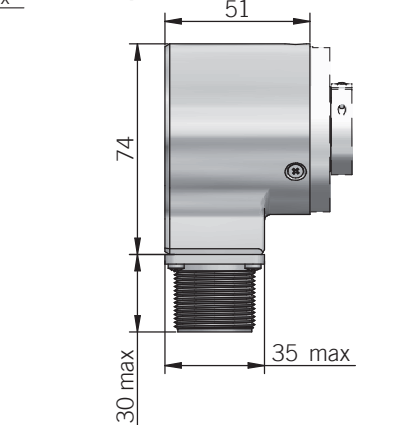

torque pin is included in model G, for model F please refer to Accessories dimensions in mm

ELECTRICAL SPECIFICATIONS

Resolution	from 1 to 2500 ppr (58 G) from 1 to 24000 ppr (58 F - 63 F / G)
Power supply¹	5 = 4,5 ... 5,5 V DC 5/28 = 4,5 ... 30 V DC (reverse polarity protection)
Power draw without load	800 mW max
Max load current	C / P = 50 mA / channel L / RS = 20 mA / channel
Electrical interface²	NPN open collector (AEIC-7273, pull-up max +30 V DC) push-pull / line driver HTL (AEIC-7272) line driver RS-422 (AELT-5000 or equivalent)
Max output frequency	250 kHz up to 6000 ppr 500 kHz from 7200 ppr
Counting direction	A leads B clockwise (shaft view)
Electromagnetic compatibility	according to 2014/30/EU directive
RoHS	according to 2015/863/EU directive
UL / CSA	certificate n. E212495

EL SERIES RESOLUTIONS

1 - 2 - 4 - 5 - 10 - 15 - 16 - 20 - 25 - 30 - 32 - 40 - 50 - 60 - 70 - 80 - 90 - 160 - 180 - 350 - 450 - 660 - 700 - 750 - 1500

ER SERIES RESOLUTIONS

100 - 120 - 128 - 150 - 200 - 240 - 250 - 256 - 300 - 360 - 400 - 480 - 500 - 512 - 600 - 625 - 720 - 800 - 900 - 1000 - 1024 - 1200 - 1250 - 1440 - 1600 - 1800 - 2000 - 2048 - 2500 - 3000 - 3600 - 4000 - 4096 - 5000 - 6000 - 7200 - 8000 - 8192 - 9000 - 10000 - 10240 - 12000 - 14400 - 16000 - 16384 - 18000 - 20000 - 20480 - 24000

please directly contact our offices for other pulses, preferred resolutions in bold

CONNECTIONS

Function	Cable C / P	Cable L / RS	7 pin J C / P	7 pin J L / RS no Zero	7 pin M C / P	7 pin M L / RS no Zero	10 pin J L / RS with Zero	10 pin M L / RS with Zero	5 pin M12 C / P	8 pin M12 L / RS	12 pin H	5 pin C C / P	8 pin C L / RS
+V DC	red	red	6	4	F	D	4 - 5	D - E	2	7	12	5	7
0 V	black	black	1	6	A	F	6	F	4	1	10	1	8
A+	green	green	3	1	C	A	1	A	3	6	5	2	1
A-	/	brown or grey	/	3	/	C	7	G	/	5	6	/	2
B+	yellow	yellow	5	2	E	B	2	B	1	4	8	4	3
B-	/	orange	/	5	/	E	8	H	/	3	1	/	4
Z+	blue	blue	4	/	D	/	3	C	5	2	3	3	5
Z-	/	white	/	/	/	/	9	I	/	8	4	/	6
⊥	shield	shield	7	7	G	G	10	J	housing	housing	9	/	/

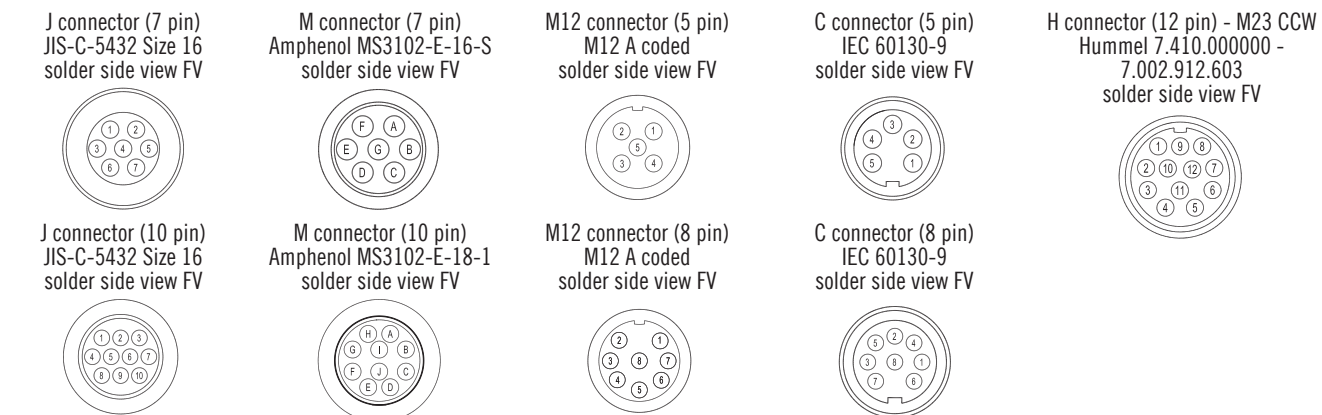

MECHANICAL SPECIFICATIONS

Bore diameter	∅ 8* / 10* / 12* / 14 / 15 mm * with supplied shaft adapter (valid for resolutions ≥ 3000 ppr)
Enclosure rating	X = IP 54 (IEC 60529) S = IP 66 (IEC 60529)
Max rotation speed	3000 rpm
Shock	50 G, 11 ms (IEC 60068-2-27)
Vibration	10 G, 10 ... 2000 Hz (IEC 60068-2-6)
Moment of inertia	4 x 10 ⁻⁶ kgm ² (95 x 10 ⁻⁶ lbf ²)
Starting torque (at +20°C / +68°F)	< 0,02 Nm (2,83 Ozin) IP 54 < 0,06 Nm (8,50 Ozin) IP 66
Bearing stage material	EN-AW 2011 aluminum
Shaft material	1.4305 / AISI 303 stainless steel
Housing material	PA66 glass fiber reinforced / painted aluminum
Bearings	n.2 ball bearings
Bearings life	10 ⁹ revolutions
Operating temperature^{3,4}	-10° ... +60°C (+14° ... +140°F) EL series -20° ... +70°C (-4° ... +158°F) ER series
Storage temperature⁴	-25° ... +70°C (-13° ... +158°F)
Fixing torque for collar clamping	1,5 Nm (212 Ozin) recommended
Weight	350 g (12,35 oz)

¹ as measured at the transducer without cable influences
² for further details refer to OUTPUT LEVELS on TECHNICAL BASICS section
³ measured on the transducer flange
⁴ condensation not allowed

MAIN FEATURES

Hollow shaft encoder series for small AC motors, thanks to compact size (only 35mm height).



- 3 channel encoder (A / B / Z) up to 2500 ppr
- Power supply up to +28 V DC with several electrical interfaces available
- Up to 300 kHz output frequency
- Cable output, connector available on cable end
- Through or blind hollow shaft diameter up to 15 mm
- Shaft fixing by collar clamping



ORDERING CODE

EL 63GB 500 S 5/28 P 8 X 3 PR .XXX

SERIES incremental encoder EL	MODEL blind hollow shaft with torque stop slot 63FB blind hollow shaft with torque pin 63GB through hollow shaft with torque pin 63PB through hollow shaft with torque stop slot 63PBF rear fixing shaft with torque pin 63PC rear fixing shaft with torque stop slot 63PCF	RESOLUTION ppr from 1 to 2500 refer to the available pulses list	ZERO PULSE without zero pulse S with zero pulse Z	POWER SUPPLY (with L electrical interface) 5 V DC 5 5 ... 28 V DC 5/28	ELECTRICAL INTERFACE NPN open collector C push-pull P line driver L power supply 5/28V - output RS-422 RS	BORE DIAMETER mm 8 mm 10 mm 12 mm 14 mm 15	ENCLOSURE RATING IP 54 X	MAX ROTATION SPEED 3000 rpm 3	OUTPUT TYPE radial cable (standard length 1,5 m) PR preferred cable lengths 2 / 3 / 5 / 10 m, to be added after OUTPUT TYPE (eg. PR5)	VARIANT custom version XXX
---	--	---	--	---	--	--	------------------------------------	---	--	--------------------------------------

63 FB / GB

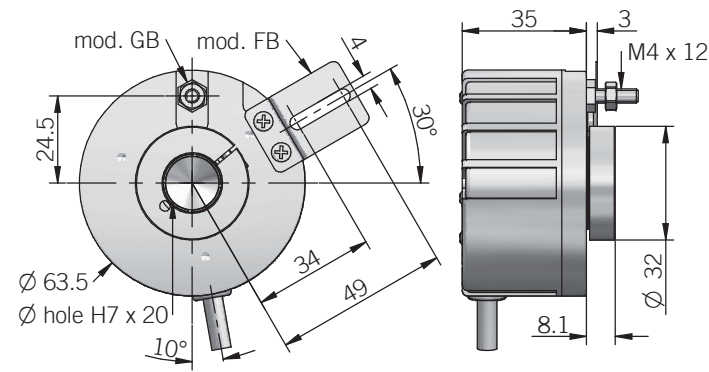

63 PB / PBF

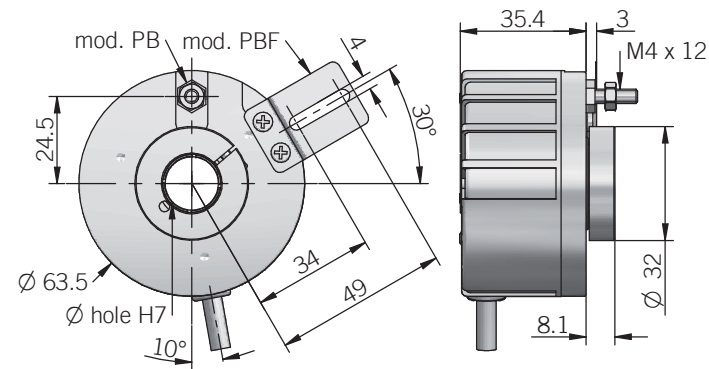

63 PC / PCF

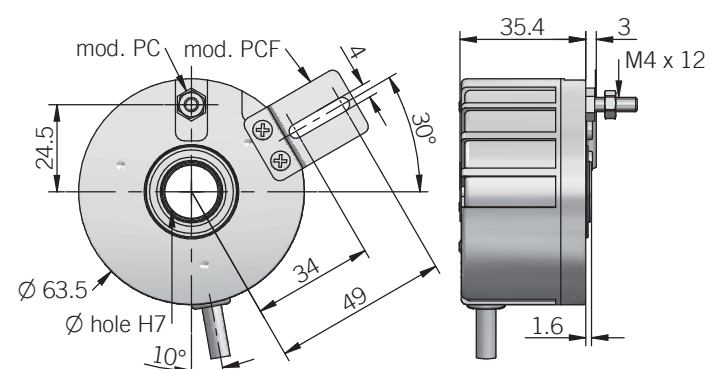

torque pin is included in model GB / PB / PC, for model FB / PBF / PCF please refer to Accessories

dimensions in mm

ELECTRICAL SPECIFICATIONS

Resolution	from 1 to 2500 ppr
Power supply¹	5 = 4,5 ... 5,5 V DC 5/28 = 4,5 ... 30 V DC (reverse polarity protection)
Power draw without load	800 mW max
Max load current	C / P = 50 mA / channel L / RS = 20 mA / channel
Electrical interface²	NPN open collector (AEIC-7273, pull-up max +30 V DC) push-pull / line driver HTL (AEIC-7272) line driver RS-422 (AELT-5000 or equivalent)
Max output frequency	300 kHz
Counting direction	A leads B clockwise (shaft view)
Electromagnetic compatibility	according to 2014/30/EU directive
RoHS	according to 2015/863/EU directive
UL / CSA	certificate n. E212495

MECHANICAL SPECIFICATIONS

Bore diameter	ø 8 / 10 / 12 / 14 / 15 mm
Enclosure rating	IP 54 (IEC 60529)
Max rotation speed	3000 rpm
Shock	50 G, 11 ms (IEC 60068-2-27)
Vibration	10 G, 10 ... 2000 Hz (IEC 60068-2-6)
Moment of inertia	4 x 10 ⁻⁶ kgm ² (95 x 10 ⁻⁶ lbf ²)
Starting torque (at +20°C / +68°F)	< 0,04 Nm (5,66 Ozin)
Bearing stage material	EN-AW 2011 aluminum
Shaft material	1.4305 / AISI 303 stainless steel
Housing material	PA 66 glass fiber reinforced
Bearings	n.2 ball bearings
Bearings life	10 ⁹ revolutions
Operating temperature^{3,4}	-10° ... +60 °C (+14° ... +140°F)
Storage temperature⁴	-25° ... +70 °C (-13° ... +158°F)
Weight	350 g (12,35 oz)

¹ as measured at the transducer without cable influences
² for further details refer to OUTPUT LEVELS on TECHNICAL BASICS section
³ measured on the transducer flange
⁴ condensation not allowed

CONNECTIONS

Function	Cable C / P	Cable L / RS
+V DC	red	red
0 V	black	black
A+	green	green
A-	/	brown or grey
B+	yellow	yellow
B-	/	orange
Z+	blue	blue
Z-	/	white
⊕	shield	shield

RESOLUTIONS

1 - 2 - 5 - 20 - 25 - **32** - 50 - 60 - 100 - 128 - 200 - 250 - 256 - **360** - 400 - 500 - 512 - 600 - 720 - 1000 - **1024** - 1440 - 1800 - **2000** - 2048 - 2500

please directly contact our offices for other pulses, preferred resolutions in bold

MAIN FEATURES

Standard encoder series for industrial environments with high mechanical resistance requirements. Specifically designed for direct mounting on motors or tachometric dynamos thanks to integrated elastic coupling which allows radial and / or axial motor shaft play.

- 3 channel encoder (A / B / Z) up to 24000 ppr
- Power supply up to +28 V DC with several electrical interfaces available
- Up to 500 kHz output frequency
- Cable or connector output
- Available with metal cover for heavy duty applications
- Integrated elastic couplig up to 10 mm bore diameter



ORDERING CODE ER 721 A M* 500 S 5/28 P 8 X 6 P R .XXX

SERIES
 incremental encoder series EL
 incremental encoder series ER

MODEL
 fixing holes ø 63,5 mm 721
 fixing holes ø 65 mm 722
 fixing holes ø 57 mm 723
 fixing holes ø 60 mm 724

FLANGE TYPE
 flange type A
 flange type B

METAL COVER
 * add for metal cover M

RESOLUTION
 ppr from 1 to 24000
 refer to the available pulses list

ZERO PULSE
 without zero pulse S
 with zero pulse Z

POWER SUPPLY
 (with L electrical interface) 5 V DC 5
 5 ... 28 V DC 5/28

ELECTRICAL INTERFACE
 NPN open collector C
 push-pull P
 line driver L
 power supply 5/28V - output RS-422 RS

BORE DIAMETER
 mm 6
 mm 8
 mm 10

ENCLOSURE RATING
 IP 54 X
 (mod. EL721 / EL722) IP 66 S

MAX ROTATION SPEED
 (IP 66) 3000 rpm 3
 (IP 54) 6000 rpm 6

OUTPUT TYPE
 cable (standard length 1,5 m) P
 preferred cable lengths 2 / 3 / 5 / 10 m, to be added after DIRECTION TYPE (eg. PR5)
 MIL connector M
 JIS-C-5432 connector J
 M12 connector M12
 M23 connector H
 IP40 IEC 60130-9 connector C
 female connector included, without female please add 162 as variant code

DIRECTION TYPE
 axial A
 radial R

VARIANT
 custom version XXX

721 A

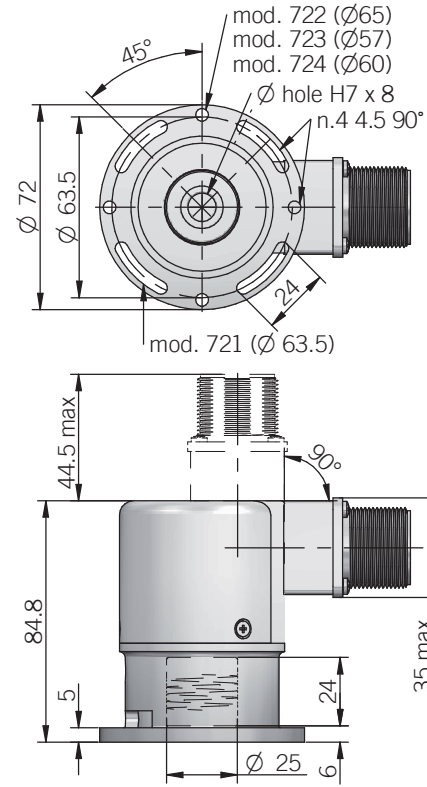

Dimensions with metal cover radial output

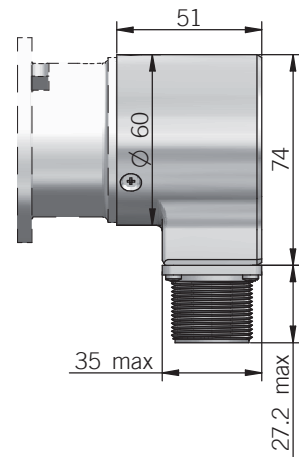

dimensions in mm

721 A IP 66

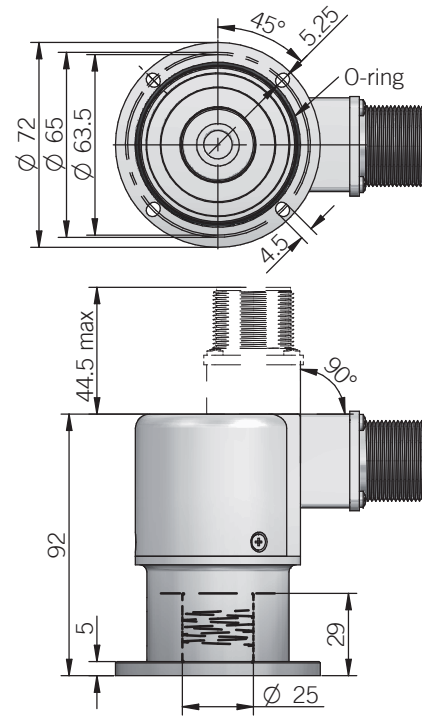

O-ring is included

Dimensions with metal cover axial output

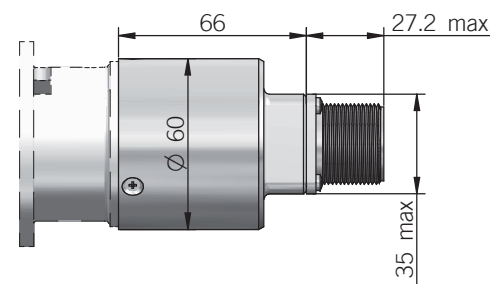

72 B flange version

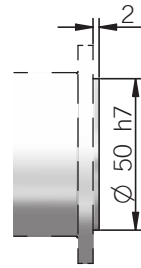

ELECTRICAL SPECIFICATIONS

Resolution	from 1 to 24000 ppr
Power supply¹	5 = 4,5 ... 5,5 V DC 5/28 = 4,5 ... 30 V DC (reverse polarity protection)
Power draw without load	800 mW max
Max load current	C / P = 50 mA / channel L / RS = 20 mA / channel
Electrical interface²	NPN open collector (AEIC-7273, pull-up max +30 V DC) push-pull / line driver HTL (AEIC-7272) line driver RS-422 (AELT-5000 or equivalent)
Max output frequency	250 kHz up to 6000 ppr 500 kHz from 7200 ppr
Counting direction	A leads B clockwise (shaft view)
Electromagnetic compatibility	according to 2014/30/EU directive
RoHS	according to 2015/863/EU directive
UL / CSA	certificate n. E212495

EL SERIES RESOLUTIONS

1 - 2 - 4 - 5 - 10 - 15 - 16 - 20 - 25 - 30 - 32 - 40 - 50 - 60 - 70 - 80 - 90 - 100* - 160 - 180 - 240* - 250* - 350 - 450 - 500* - 660 - 700 - 750 - 900* - 1000* - 1024* - 1250* - 1300* - 1500 - 1800* - 2000* - 2048* - 2500*

* only with model EL721 / EL722 with "S" enclosure rating

ER SERIES RESOLUTIONS

100 - 120 - 128 - 150 - 200 - 240 - 250 - 256 - 300 - 360 - 400 - 480 - 500 - 512 - 600 - 625 - 720 - 800 - 900 - 1000 - 1024 - 1200 - 1250 - 1440 - 1600 - 1800 - 2000 - 2048 - 2500 - 3000 - 3600 - 4000 - 4096 - 5000 - 6000 - 7200 - 8000 - 8192 - 9000 - 10000 - 10240 - 12000 - 14400 - 16000 - 16384 - 18000 - 20000 - 20480 - 24000

please directly contact our offices for other pulses, preferred resolutions in bold

CONNECTIONS

Function	Cable C / P	Cable L / RS	7 pin J C / P	7 pin J L / RS no Zero	7 pin M C / P	7 pin M L / RS no Zero	10 pin J L / RS with Zero	10 pin M L / RS with Zero	5 pin M12 C / P	8 pin M12 L / RS	12 pin H	5 pin C C / P	8 pin C L / RS
+V DC	red	red	6	4	F	D	4 - 5	D - E	2	7	12	5	7
0 V	black	black	1	6	A	F	6	F	4	1	10	1	8
A+	green	green	3	1	C	A	1	A	3	6	5	2	1
A-	/	brown or grey	/	3	/	C	7	G	/	5	6	/	2
B+	yellow	yellow	5	2	E	B	2	B	1	4	8	4	3
B-	/	orange	/	5	/	E	8	H	/	3	1	/	4
Z+	blue	blue	4	/	D	/	3	C	5	2	3	3	5
Z-	/	white	/	/	/	/	9	I	/	8	4	/	6
≡	shield	shield	7	7	G	G	10	J	housing	housing	9	/	/

J connector (7 pin)
JIS-C-5432 Size 16
solder side view FV

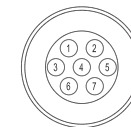

J connector (10 pin)
JIS-C-5432 Size 16
solder side view FV

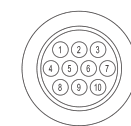

M connector (7 pin)
Amphenol MS3102-E-16-S
solder side view FV

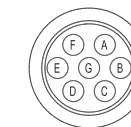

M connector (10 pin)
Amphenol MS3102-E-18-1
solder side view FV

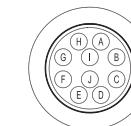

M12 connector (5 pin)
M12 A coded
solder side view FV

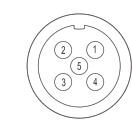

M12 connector (8 pin)
M12 A coded
solder side view FV

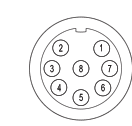

C connector (5 pin)
IEC 60130-9
solder side view FV

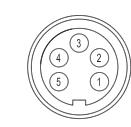

C connector (8 pin)
IEC 60130-9
solder side view FV



H connector (12 pin) - M23 CCW
Hummel 7.410.000000 -
7.002.912.603
solder side view FV

