

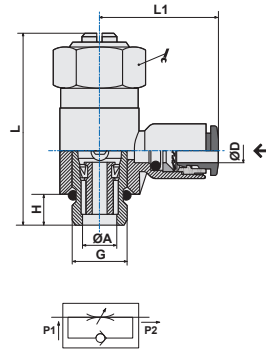

T-RAP Flow Controls

T28 Valve - T29 Cylinder - T30 Bidirectional

PART	ØD	G	ØA	H	L1	L		
T2804M5	4	M5	2,0	4	19,0	22,5	8	25
T280418	4	1/8	5,0	5,5	21,1	34,0	14	25
T2806M5	6	M5	2,0	4	22,0	22,5	8	25
T280618	6	1/8	5,0	5,5	24,3	34,0	14	25
T280614	6	1/4	6,0	6,5	25,5	42,0	17	25
T280818	8	1/8	5,0	5,5	24,8	34,0	14	25
T280814	8	1/4	6,0	6,5	26,5	42,0	17	25
T280838	8	3/8	6,5	7,5	28,0	52,0	20	10
T281014	10	1/4	6,0	6,5	28,4	42,0	17	25
T281038	10	3/8	6,5	7,5	29,9	52,0	20	10
T281238	12	3/8	6,5	7,5	31,4	52,0	20	10



PART	ØD	G	ØA	H	L1	L		
T2904M5	4	M5	2,0	4	19,0	22,5	8	25
T290418	4	1/8	5,0	4	21,1	34,0	14	25
T2906M5	6	M5	2,0	4	22,0	22,5	8	25
T290618	6	1/8	5,0	5,5	24,3	34,0	14	25
T290614	6	1/4	6,0	6,5	25,5	42,0	17	25
T290818	8	1/8	5,0	5,5	24,8	34,0	14	25
T290814	8	1/4	6,0	6,5	26,5	42,0	17	25
T290838	8	3/8	6,5	7,5	28,0	52,0	20	10
T291014	10	1/4	6,0	6,5	28,4	42,0	17	25
T291038	10	3/8	6,5	7,5	29,9	52,0	20	10
T291012	10	1/2	10,0	9	30,0	61,0	26	10
T291238	12	3/8	6,5	7,5	31,4	52,0	20	10
T291212	12	1/2	10,0	9	34,9	61,0	26	10

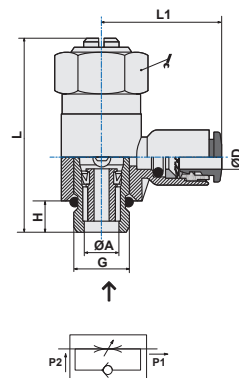

PART	ØD	G	ØA	H	L1	L		
T3004M5	4	M5	2,0	4	19,0	22,5	8	25
T300418	4	1/8	5,0	4	21,1	34,0	14	25
T3006M5	6	M5	2,0	4	22,0	22,5	8	5
T300618	6	1/8	5,0	5,5	24,3	34,0	14	25
T300614	6	1/4	6,0	6,5	25,5	42,0	17	25
T300818	8	1/8	5,0	5,5	24,8	34,0	14	25
T300814	8	1/4	6,0	6,5	26,5	42,0	17	25
T300838	8	3/8	6,5	7,5	28,0	52,0	20	10
T301014	10	1/4	6,0	6,5	28,4	42,0	17	25
T301038	10	3/8	6,5	7,5	29,9	52,0	20	10
T301238	12	3/8	6,5	7,5	31,4	52,0	20	10
T301212	12	1/2	10,0	9	34,9	61,0	26	10

