



# ROUND VACUUM CUPS WITH BALL VALVE AND SELF-LOCKING SUPPORT

These cups represent a true mobile clamping system.

They are composed of:

- A sturdy aluminium support with a wide surface at the base limited by a seal whose purpose is to fix it to the bearing surface.
- A standard circular flat cup which is cold fitted onto the upper part of the support for gripping the load.
- A ball valve that opens up creating vacuum, only when activated by the load to be gripped.
- Two quick couplings for vacuum connection.

The gripping plane of these cups is covered with a special non-slip plastic coating, which is particularly suited for clamping glass and smooth marble.

The detection of vacuum, for gripping and releasing the support, can be made via three-way vacuum valves or solenoid valves.

All cups with self-locking support of this and other ranges with the gripping plane at the same height can be used simultaneously, even if they are of different types or have different sizes.

**Note:** Available with support for mechanical fixing with code 28, instead of 18.

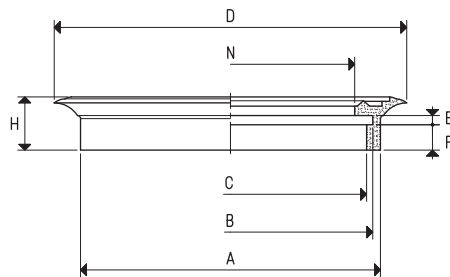

## SPARE VACUUM CUPS

Item	Force Kg	Volume cm <sup>3</sup>	A Ø	B Ø	C Ø	D Ø	E	F	H	N Ø	Weight g
01 85 15 M *	14.18	13.0	68	63	59	85	3	7	17	53	26.2
01 110 10 M *	23.74	24.9	96	91	87	114	3	8	17	80	40.1
01 150 10 M *	45.00	75.7	133	125	118	154	4	11	23	117	98.3
01 250 20 *	122.60	200.0	235	227	220	254	4	11	23	220	188.6

\* Complete the code indicating the compound: A= oil-resistant rubber; N= natural para rubber; S= silicone; BA= stain-resistant Biond

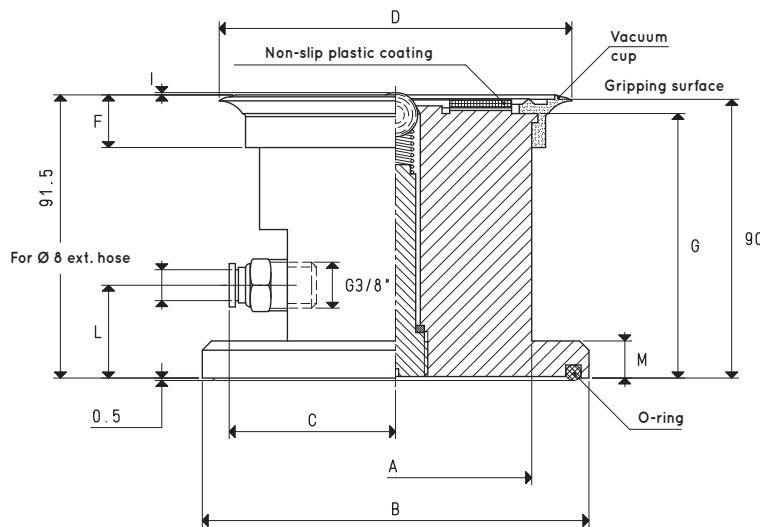

## VACUUM CUPS WITH BALL VALVE AND SELF-LOCKING SUPPORT

Item	Force Kg	A Ø	B Ø	C	D Ø	F	G	I	L	M	Vacuum cup item	O-ring item	Weight Kg
18 85 15/90 MT *	14.18	60	98	42	85	17	85.0	1	30	12	01 85 15 M	00 16 06	0.880
18 110 10/90 MT *	23.74	88	125	51	114	17	85.5	1	30	12	01 110 10 M	00 16 07	1.704
18 150 10/90 MT *	45.00	120	165	68	154	23	85.0	1	30	12	01 150 10 M	00 16 08	3.158
18 250 20/90 MT *	122.60	223	270	121	254	23	85.0	1	33	15	01 250 20	00 18 09	10.322

\* Complete the code indicating the compound: A= oil-resistant rubber; N= natural para rubber; S= silicone; BA= stain-resistant Biond

Note: The force of the vacuum cups indicated in the table represents 1/3 of the value of the theoretical force calculated at a level of vacuum of -75 KPa and a factor of safety 3.

Transformation ratio: N (newton) = Kg x 9.81 (force of gravity)      inch =  $\frac{\text{mm}}{25.4}$  ; pounds =  $\frac{\text{g}}{453.6} = \frac{\text{Kg}}{0.4536}$