

BASIC VACUUM CUP HOLDERS FIX

These are simple nickel-plated brass threaded bushes with ring nuts for height adjustment and with male and female threaded ends, one to assemble the vacuum cup with support and the other for the quick coupling connecting the suction hose.

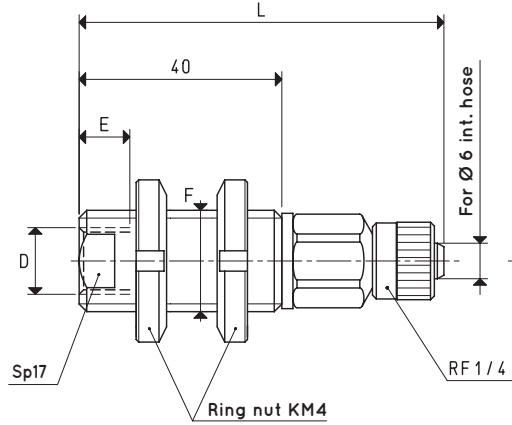

VERSION 02 91 01

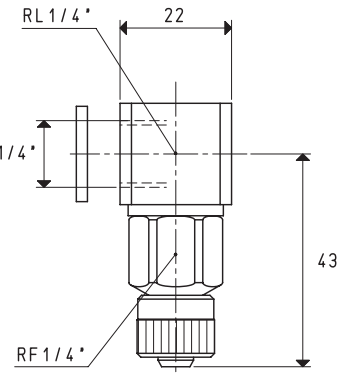

VERSION 02 91 01 L

VACUUM CUP HOLDERS WITH STRAIGHT QUICK COUPLER FOR PLASTIC HOSE Ø 6 X 8

Item	D Ø	E	F Ø	L	Weight g
02 91 01	G1/4"	10	M20 x 1	74	162

Note: To order vacuum cup holders with L fittings, add the letter L to the code.

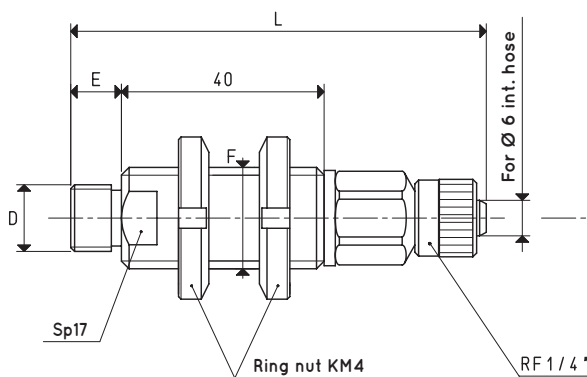

VERSION 02 91 . .

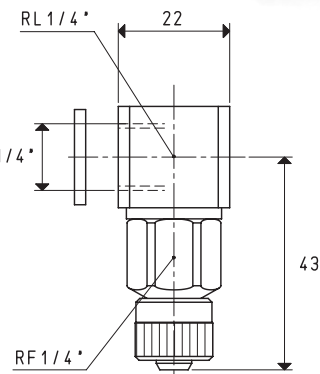

VERSION 02 91 . . L

VACUUM CUP HOLDERS WITH STRAIGHT QUICK COUPLER FOR PLASTIC HOSE Ø 6 X 8

Item	D Ø	E	F Ø	L	Weight g
02 91 05	G1/4"	10	M20 x 1	84	170
02 91 06	G3/8"	10	M20 x 1	84	174

Note: To order vacuum cup holders with L fittings, add the letter L to the code.