

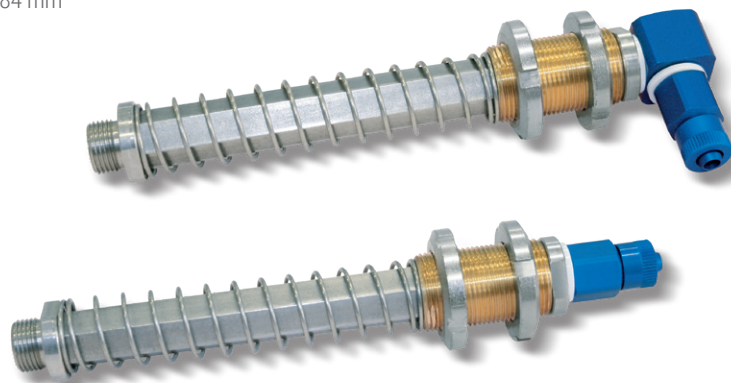

# SPECIAL ANTI-ROTATION VACUUM CUP HOLDERS WITH MALE THREADED CONNECTOR

The actual springing stroke is:

- For height C= 55 mm      37 mm
- For height C= 110 mm    84 mm



3D drawings are available on [vuototecnica.net](http://vuototecnica.net)

2

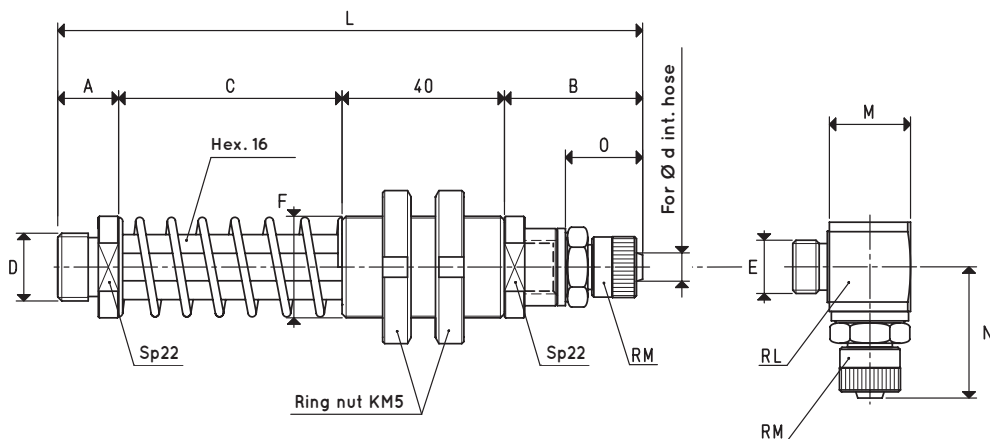

VERSION 06 . . . . .

VERSION 06 . . . . . L

## VACUUM CUP HOLDERS WITH STRAIGHT QUICK COUPLER FOR PLASTIC HOSE

Item	A	B	C	D Ø	d Ø	E Ø	F Ø	L	M	N	O	RL	RM	Weight g
<b>06 55 90</b>	15	34	55	G1/4"	6	G1/4"	M25 x 1.5	144	21.0	32.0	18.5	G1/4"	G1/4"	314
<b>06 55 91</b>	15	34	55	G3/8"	6	G1/4"	M25 x 1.5	144	21.0	32.0	18.5	G1/4"	G1/4"	320
<b>06 55 92</b>	15	40	55	G3/8"	9	G3/8"	M25 x 1.5	150	21.5	35.5	22.0	G3/8"	G3/8"	330
<b>06 55 93</b>	15	40	55	G1/2"	9	G3/8"	M25 x 1.5	150	21.5	35.5	22.0	G3/8"	G3/8"	332
<b>06 55 94</b>	15	34	55	M12	6	G1/4"	M25 x 1.5	144	21.0	32.0	18.5	G1/4"	G1/4"	318
<b>06 55 95</b>	15	40	55	M12	9	G3/8"	M25 x 1.5	150	21.5	35.5	22.0	G3/8"	G3/8"	328
<b>06 55 96</b>	15	40	55	M16	9	G3/8"	M25 x 1.5	150	21.5	35.5	22.0	G3/8"	G3/8"	330
<b>06 110 90</b>	15	34	110	G1/4"	6	G1/4"	M25 x 1.5	199	21.0	32.0	18.5	G1/4"	G1/4"	374
<b>06 110 91</b>	15	34	110	G3/8"	6	G1/4"	M25 x 1.5	199	21.0	32.0	18.5	G1/4"	G1/4"	380
<b>06 110 92</b>	15	40	110	G3/8"	9	G3/8"	M25 x 1.5	205	21.5	35.5	22.0	G3/8"	G3/8"	390
<b>06 110 93</b>	15	40	110	G1/2"	9	G3/8"	M25 x 1.5	205	21.5	35.5	22.0	G3/8"	G3/8"	392
<b>06 110 94</b>	15	34	110	M12	6	G1/4"	M25 x 1.5	199	21.0	32.0	18.5	G1/4"	G1/4"	378
<b>06 110 95</b>	15	40	110	M12	9	G3/8"	M25 x 1.5	205	21.5	35.5	22.0	G3/8"	G3/8"	388
<b>06 110 96</b>	15	40	110	M16	6	G3/8"	M25 x 1.5	205	21.5	35.5	22.0	G3/8"	G3/8"	390

Note: To order vacuum cup holders with L fittings, add the letter L to the code.

Transformation ratio: N (newton) = Kg x 9.81 (force of gravity)

$$\text{inch} = \frac{\text{mm}}{25.4} ; \text{pounds} = \frac{\text{g}}{453.6} = \frac{\text{Kg}}{0.4536}$$